

## TRACTOR (Fig. 7)

1. Glue Parts 28, 29 and 30 in numerical sequence.
2. Glue Parts 31 (x2) and Part 32 together as shown, keeping Parts 31 parallel.
3. Glue Shovel Assembly to Tractor.
4. Cut length of Wire approximately 7/8" for Steering Column, glue to Parts 28 and 33.

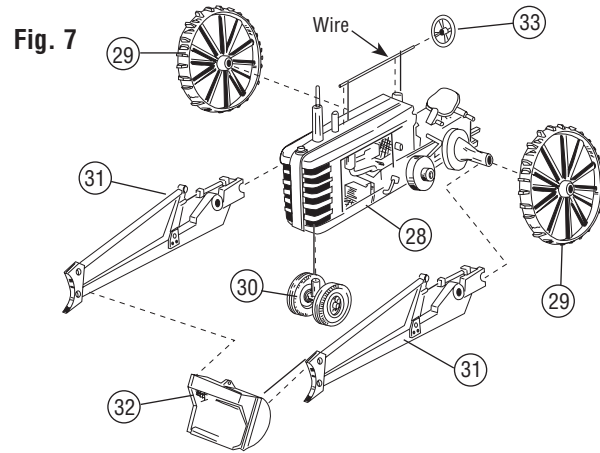

## SCALE (Fig. 8)

1. Assemble and glue Parts 34 and 35.
2. Butt Parts 36 and 37 up to flanges on Part 38 (Roof). Keep Parts 36 and 37 parallel to each other and perpendicular to Part 38 and glue. **NOTE:** Roof should overhang more on Part 37 than Part 36.
3. Position and glue Parts 36 and 37 to Part 34.
4. Position and glue Part 39 to Part 38.

## SCALE PLATFORM (Fig. 8)

1. Glue Basswood Sections J and K to edges of Basswood Section E. Trim excess wood.

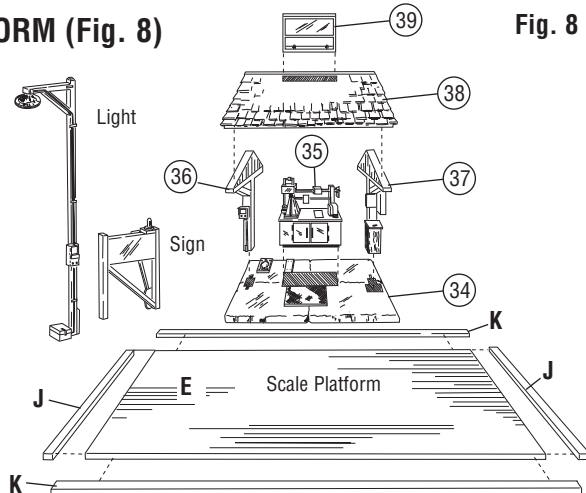

## FINAL ASSEMBLY

After all assemblies have been completed, attach to layout in desired locations. Pour Coal into individual Bins and Hopper. The extra Castings included with this kit are details to enhance your scene and make it unique. Add lights to your scene quickly and easily using the Woodland Scenics Just Plug® Lighting System. Visit [woodlandscenics.com](http://woodlandscenics.com) to learn more.

Read through instructions before beginning. Trackside Scenes™ are a series of highly detailed and imaginative kits that present life often seen from the perspective of a passing locomotive.

## INTRODUCTION

## TS153

## Otis Coal Company

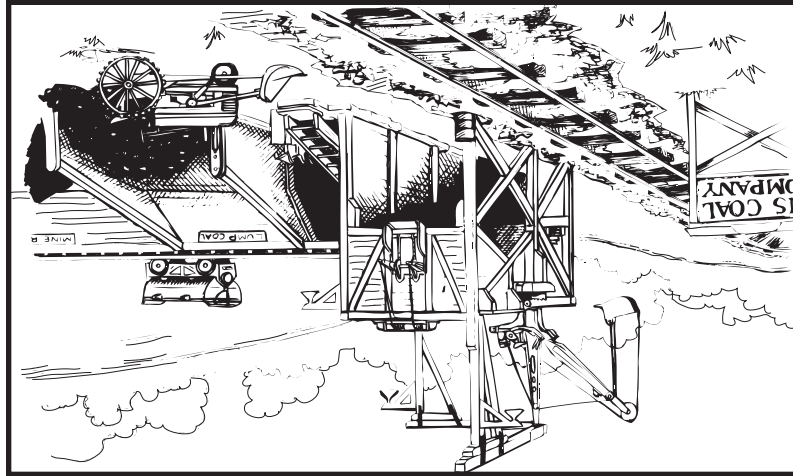

## COMPLETE TERRAIN AND LANDSCAPE SYSTEMS

If it exists in nature, you can model it with the Terrain and Landscape Systems. Add contours, rocks and soil to create your base terrain, then model any type of vegetation from ground cover to grasses, bushes, weeds and trees. Create water features from the smallest trickling stream to a small pond, large lake or thunderous waterfall. The Terrain and Landscape Systems make it easy to model any geographical area with incredible realism.

Check out The Scenery Manual (C1207) to learn the secrets of modeling realistic layouts. Detailed color illustrations and photos show you how to easily create terrain and landscape, as well as how to construct, detail and place structures. Visit us at [woodlandscenics.com](http://woodlandscenics.com) for more resources, how-to videos, tips, techniques and ideas.

We make every effort to ensure our kits are manufactured complete. However, if this kit is missing a part, please make note of kit name, number and missing part. Contact the Sales and Customer Service Department at PO Box 98, Linn Creek, MO 65052, 573-346-5555 or [sales@woodlandscenics.com](mailto:sales@woodlandscenics.com).

**CAUTION:** Cutting tools recommended. Use with care.

Conforms to Health Requirements of ASTM D4236

**MODELING AND CARE INFORMATION** This kit suggests the use of products that may stain or cause damage. Take care to cover project area and clothing appropriately. Follow recommendations for use and cleanup.

## WOODLAND SCENICS®

Manufactured by **WOODLAND®**  
PO Box 98, Linn Creek, MO 65052  
Phone 573-346-5555 • Fax 573-346-3768  
[woodlandscenics.com](http://woodlandscenics.com)

XINSTTS153 K9 ©1999 O CO

## GENERAL INSTRUCTIONS

### Clean and Fit Castings

- Wash Castings in warm, soapy water. Rinse and let dry.
- Castings have parting lines, flash and stems that need to be removed. To remove, scrape off with a hobby knife, file or sand.
- If Castings do not align properly, fit them by removing metal with a hobby knife or file. Metal Castings are somewhat brittle and should be handled carefully. If they are bent or warped, straighten by placing on flat surface and pushing down high areas.

### Glue Castings

- Assemble Castings with fast setting epoxy or super glue. We prefer super glue.
- Allow glue to dry completely before moving to next construction step.

### Paint Castings

- We recommend the Mini-Scene® Paint Set (M125). It includes detailed instructions on painting and weathering. High-quality acrylic hobby paints will also work.
- Plan ahead. It may be easier to pre-paint certain Castings prior to assembly. If you pre-paint Castings, scrape paint from glue points.

## APPLY TURF

1. Locate an area on layout for Otis Coal Company. If area is glossy, sand lightly.
2. Spray area to be landscaped with Scenic Cement using the Scenic Sprayer. Sprinkle Turf over glue until covered completely. Seal with a final coat of Scenic Cement and let dry.
  - Use Green Blend Blended Turf and Earth Fine Turf as desired. Blend colors until Turf looks natural. An area with only one color rarely occurs in nature. Spray Scenic Cement between layers of Turf.
  - Blend Turf with surrounding scenes.
  - If desired, leave some areas clear of Turf to model erosion.

## APPLY BALLAST

- Pour Ballast onto track area. Brush from rails and top of ties. Mist Scenic Cement onto Ballast with the Scenic Sprayer or eyedropper, then saturate for a strong bond.

## APPLY DRY TRANSFER DECALS

- Apply Decals to a clean, dry, dust-free surface. Cut out Decal, leaving slight edge. Avoid handling the back. Position in desired location and rub over entire decal area with dull pencil or burnisher. Lift away carrier sheet carefully. Place backing paper over Decal and rub again for maximum adhesion.
- Press into crevices and corners while transferring.

## KIT CONTENTS

89 Lead-Free, Metal Castings  
1 sheet Dry Transfer Decals  
2 sheets Scribed Basswood  
2 7/8 in x 2 7/8 in (7.3 cm x 7.3 cm)  
1 Elastic String 24 in (60.9 cm)  
2 Wires 12 in (30.4 cm) ea  
Medium Green Foliage 4.32 in² (27.8 cm²)  
Green Blend Blended Turf 3.6 in² (58.9 cm²)  
Earth Fine Turf 3.6 in² (58.9 cm²)  
Light Gray Fine Ballast 3.6 in² (58.9 cm²)  
Mine Run Coal 3.6 in² (58.9 cm²)  
Lump Coal 3.6 in² (58.9 cm²)

Metal Castings Include:  
Tie Mill Assembly  
Dipping Shed Assembly  
Steam Engine Assembly  
Conveyor Assembly  
Saw and Track Assembly  
Lights  
Logs  
Barrels  
Pallets

## ADDITIONAL MATERIALS NEEDED TO COMPLETE SCENE

- Primer
- Acrylic Paint
- Paintbrushes
- Hobby Knife or File
- Hob-e-Tac® (S195)
- Scenic Cement™ (S191)
- Scenic Sprayer™ (S192)
- Scenic Glue™ (S190)
- Super Glue

# ASSEMBLY INSTRUCTIONS

## COAL BUNKER (Fig. 1 and 2)

1. Assemble and glue Parts 1-7 (Fig. 1). **NOTE:** Parts 1 and 2, and Parts 3 and 4 overlap.
2. Cut all Basswood pieces as indicated with a hobby knife (Fig. 2).
3. Trim and notch Basswood Part F and glue in place (Fig. 1).
4. Glue Parts 8 and 9 to Assembly (Fig. 1).

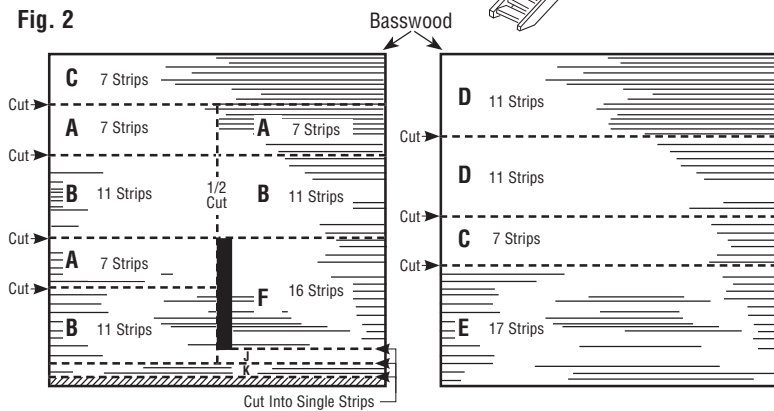
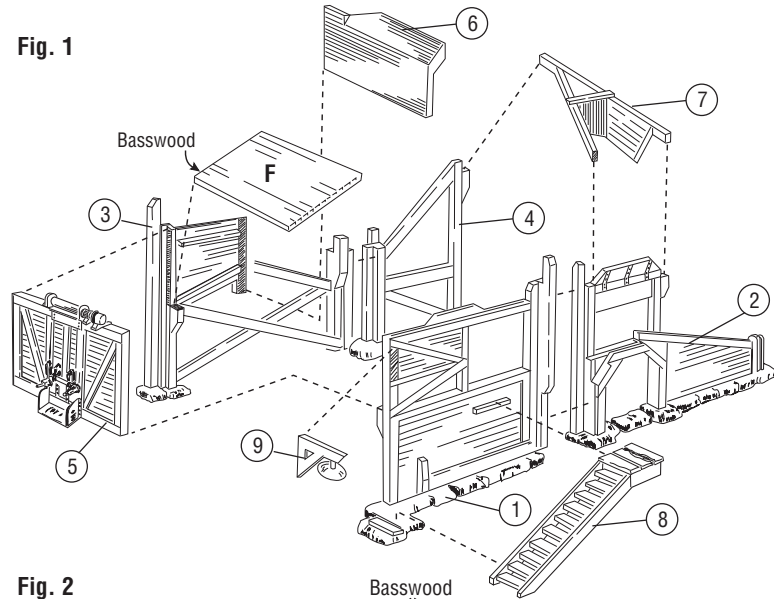

## CAR (Fig. 6)

1. Glue Parts 27 (x2) together.
2. Glue Part 26 to Parts 27 (x2).
3. Place or glue on track in desired location.

Fig. 6

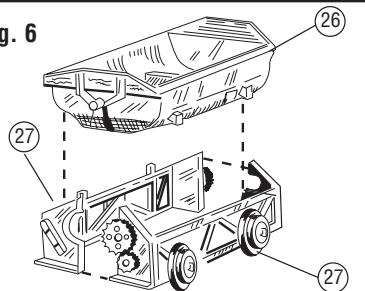

## CRANE AND BUNKER (Fig. 3 and View 1, 2 and 3)

1. Glue Parts 8, 10 and 11 to Bunker Assembly. **NOTE:** See View 1 to determine proper placement of Part 11.
2. Assemble and glue Parts 12-16 in numerical sequence.
3. Attach Elastic String, View 2 and 3.
4. Make and attach Wire support for Part 40 (Bucket) View 2.
5. Glue Elastic String to Bucket.
6. Glue Parts 17, 18 and Crane Assembly to Bunker Assembly. **NOTE:** If rotating crane is desired, do not glue Crane Pin.
7. Attach Parts 9 (x2) to Assembly.

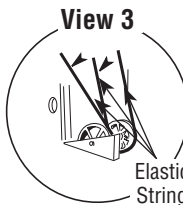
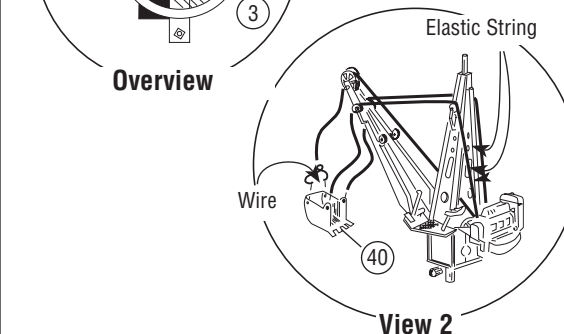
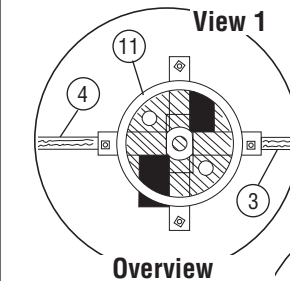
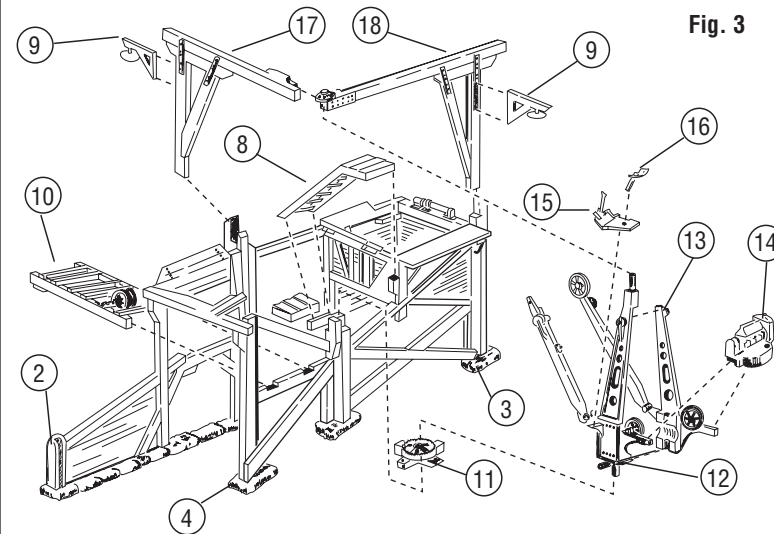

## COAL BIN (Fig. 4 and 5)

1. Assemble and glue Parts 19 (x4) and Parts 20 (x2) to Basswood Walls (Section A, B, C and D) (Fig. 4). Assemble in progression from left to right, placing edge of each Basswood section on outside of support ridge of each wall section. **NOTE:** Pay careful attention to the difference in Parts 19 and Parts 20 (Fig. 4). Keep assembly straight because track sections will be laid on top of it.
2. Connect Bin Assembly to Tower Assembly by gluing Basswood Walls A and B from Part 19 to Part 2.
3. Assemble and glue Track Sections (Parts 21, x3) and Part 22 to top of Bin Assembly. Begin on Part 2. **NOTE:** If Track Sections are too long, file until Sections butt together in center of supports.
4. Glue Part 23 to Part 22.
5. Glue Parts 24 and 16 to Part 23.
6. Attach Elastic String to bottom Pulley on Part 23 and around Pulley on Part 10, over Pulleys on Parts 21 and 22, over top Pulley on Part 23 and return to bottom pulley as shown.
7. Attach Wire to Track Sections, Part 21(x3) and Part 22 as shown in View 4. Do not extend Wire Rail beyond the Track end.

Fig. 4

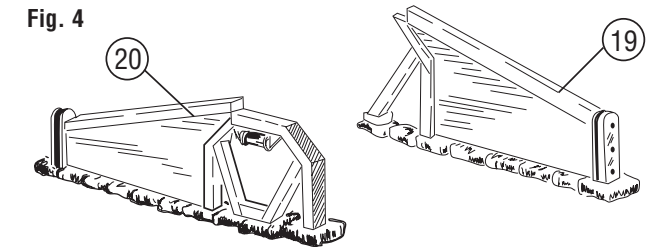

View 4

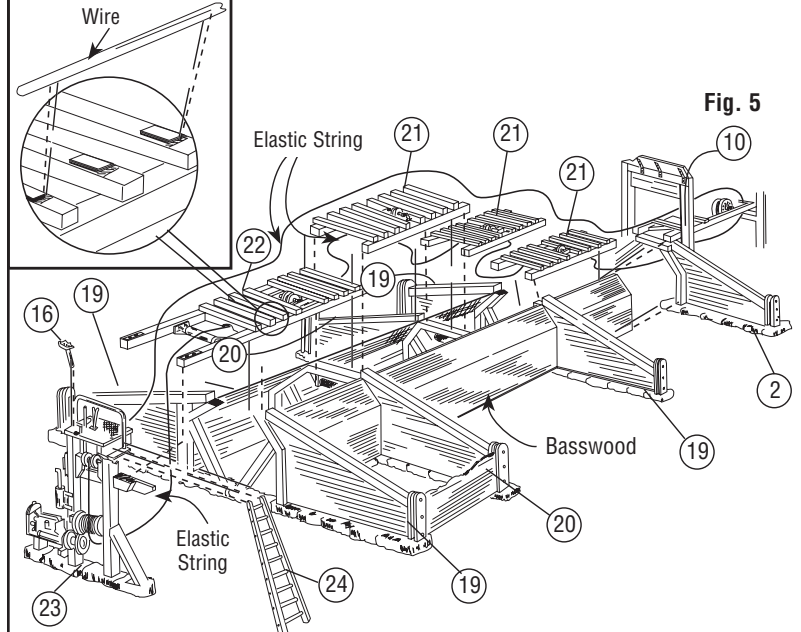

Fig. 5

