



PF5186

# Country Cottage Instructions

HO Scale 1:87



**M**odel Grandma and Grandpa's cozy cottage, a young family's first home or give this vintage Victorian cottage the run-down look of an abandoned shack. This charming and versatile structure is loaded with detail and provides unlimited choices for layout placement.



**WOODLAND SCENICS®**

**SAFETY INFORMATION**  
**WARNING:** Sharp objects.  
Choking Hazard! Small parts.  
Not intended for children under 3 yrs. Adult supervision required.

**CAUTION**  
Cutting tools recommended. Use with care.

**MODELING AND CARE INFORMATION**  
This kit suggests the use of products which may stain or cause damage. Take care to cover project area and clothing appropriately. Follow recommendations for use and clean up.

We make every effort to ensure our kits are manufactured complete. However, if this kit is missing a part, please make note of the kit's model number and missing part, and contact the Woodland Scenics Sales and Customer Service Department at PO Box 98, Linn Creek, MO 65052, 573-346-5555 or sales@woodlandscenics.com  
XPF5186INST ©2010 O CO Printed by a certified Green Printer

**Building Kit Contents**

- Building Shell
- Roof
- 3 sets of Sprues
- 8 Phillips Flathead Screws
- Window Details (Pre-printed Window Treatments and Clear Window Material)
- Blackout Paper

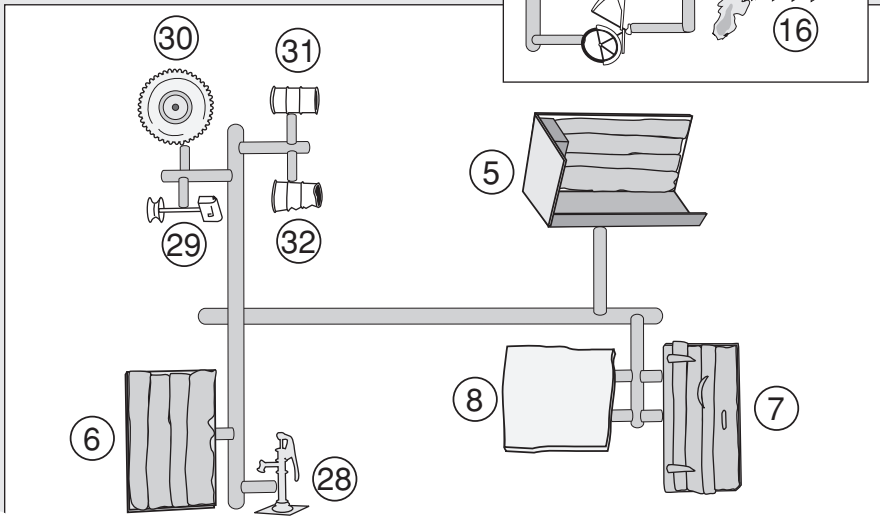
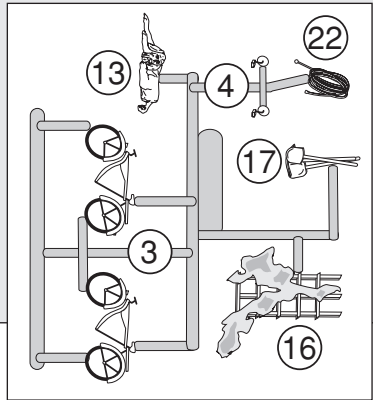
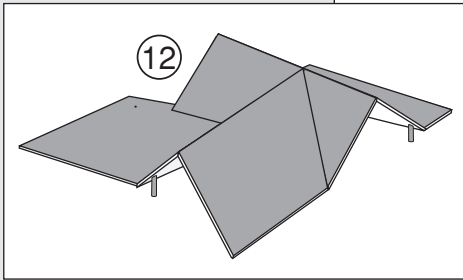
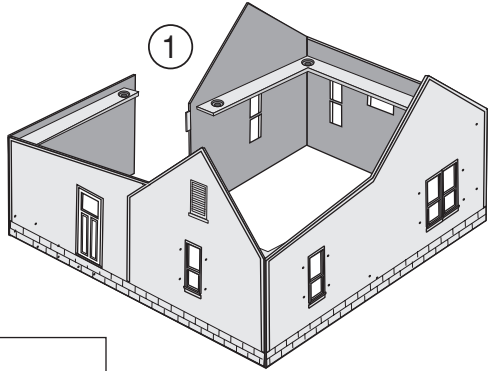



## 1. Building and Detail Preparation

- Remove any mold flash from Building Shell and Roof ⑫ using a hobby knife and sandpaper (Fig. 1a). Mold flash may need to be cleaned from placement holes.
- Wash Building, Roof and Details (on sprue) in warm, soapy water using a mild detergent. Rinse and let dry.
- Remove Details from sprues using a hobby knife (or flush cutting shears) (Fig. 1b).

**NOTE:** Do not remove placement posts.

- Sand off any mold flash or parting lines from Details.

**NOTE:** Do not sand placement posts.

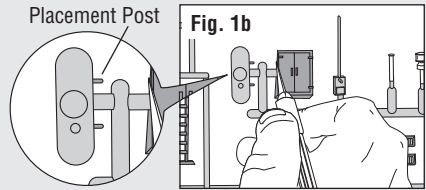
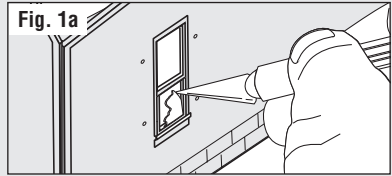

## 2. Install Side Wall

- Align notches and tabs on Side Wall ② with Building ① (Fig. 2a).
- Apply glue along inside seams.
- Make sure Side Wall and Building are level along the bottom (Fig. 2b).

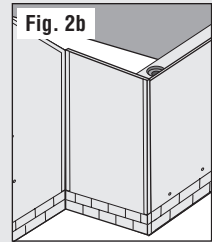
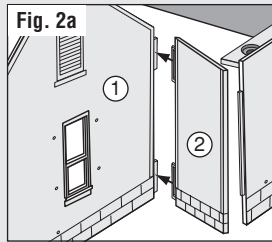

## 3. Assemble Bicycle and Outhouse

- Glue Bicycle Pedal 2x ④ to Bicycle 2x ③ (Fig. 3a).
- Assemble and glue outhouse pieces together. Glue part ⑥ to ⑤, then attach part ⑦ and part ⑧. (Fig. 3b)

**NOTE:** Outhouse must be assembled using cyanoacrylate adhesive (CA glue).

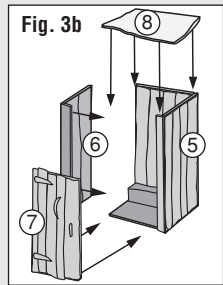
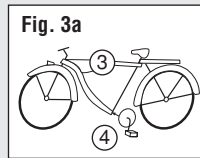

## 4. Prime and Paint

**NOTE:** Do not prime or paint placement posts.

- Apply a thin coat of primer to Building and Details.
- Allow to dry.
- Paint Building and Details, as desired.
- Allow to dry.

**OPTION:** Add a realistic mortar-look to the brickwork that runs along the bottom of the house (see *Tips and Techniques*, page 6).

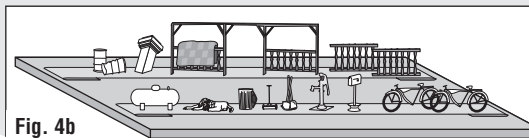
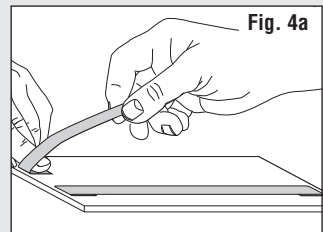

**TIP!** To make priming and painting easier, attach Details (unexposed side down) to loops of masking tape on a piece of cardboard (Fig. 4a and 4b).

## 5. Install Window Details

Position printed side of Window Treatments toward inside of Building. If clear window treatments are preferred, use the Clear Window Material.

- Remove protective film from Pre-printed Window Treatments.
- Cut out Window Treatments along the cut-lines.
- Place Building on its front face with the bottom toward you.
- Center Window Treatment over window on inside of Building.
- Carefully dab a small amount of glue around edges (Fig. 5a).
- Repeat for each set of window openings.

Fig. 5a

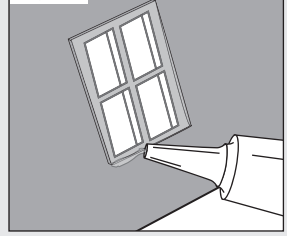

## 6. Install Porch and Railings

- Align tabs on Porch (9) in notches, then apply glue on tabs and along underside seam (Fig. 6a).
- Glue Side Railing 2x (10) to Front Railing (11). When set, glue in place. (Fig. 6b)

Fig. 6a

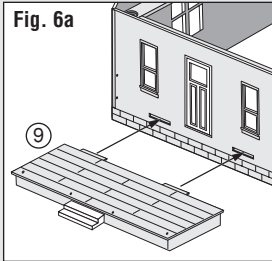
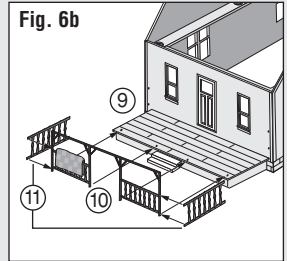

Fig. 6b



## 7. Install Roof

- Place Roof (12) on Building. Align top of Front Railing with notch in on underside of Roof (Fig. 7a). Dab on glue to secure in place.
- Install Phillips Flathead Screws 8x (Fig. 7b).

Fig. 7a

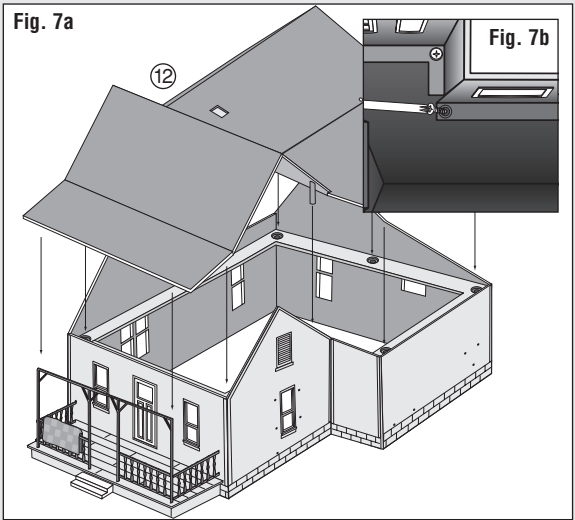
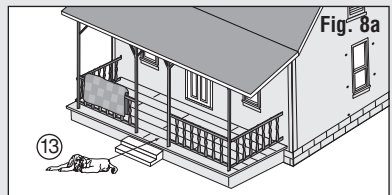

Fig. 7b

## 8. Install Details

To install Details, align placement posts in placement holes, then apply a tiny amount of glue on inside of building. Use tweezers to make installing Details easier.

**NOTE:** Dog (13) does not have a placement post.



Front (Fig. 8a): Dog (13)

## 8. Install Details cont.

Fig. 8b

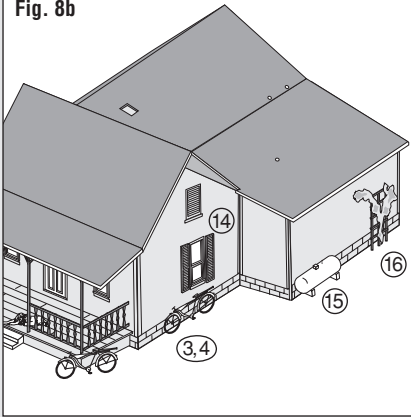

**Right Side** (Fig. 8b): Shutters 2x (14),  
Assembled Bicycles (3,4), Propane Tank (15),  
Trellis with Flowers (16)

**NOTE:** Bicycles do not have placement posts.

Fig. 8c

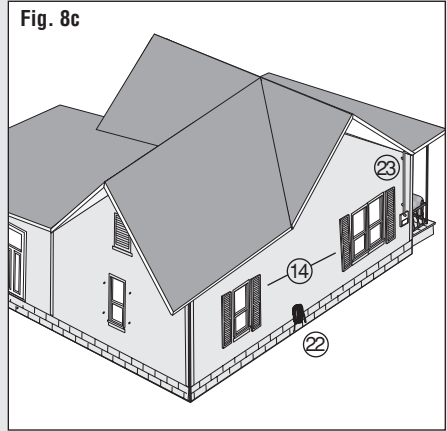

**Left Side** (Fig. 8c): Shutters 4x (14), Garden  
Hose (22), Meter Box (23)

Fig. 8d

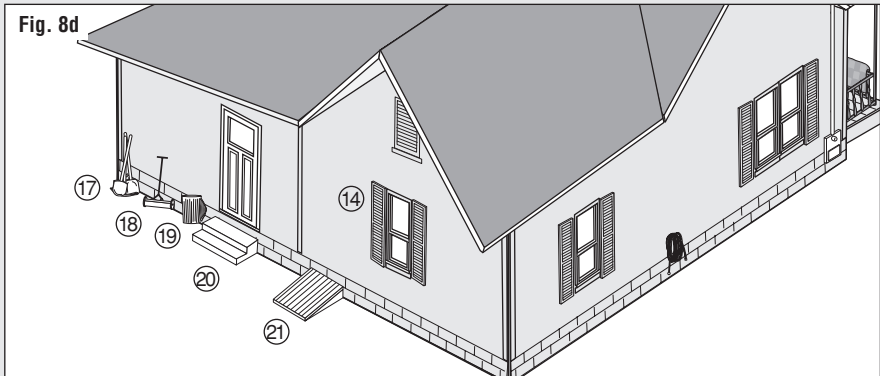

**Back** (Fig. 8d): Shovels (17), Push Mower (18), Trashcan with Lid (19), Back Steps (20), Storm Door (21), Shutters 2x (14)

Fig. 8e

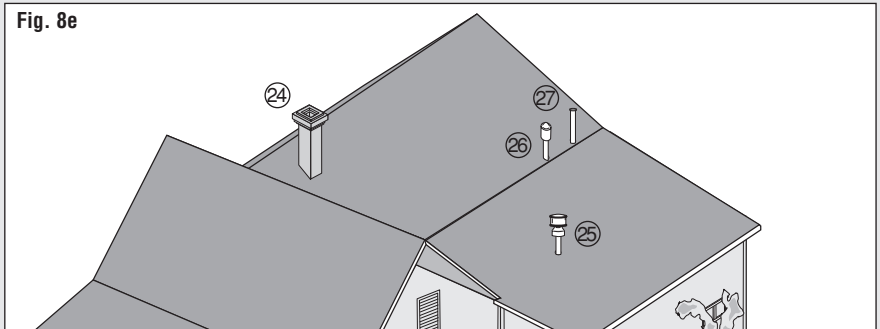

**Roof** (Fig. 8e): Chimney (24), Large Vent (25), Small Vent (26), Pipe Vent (27)

Fig. 8f

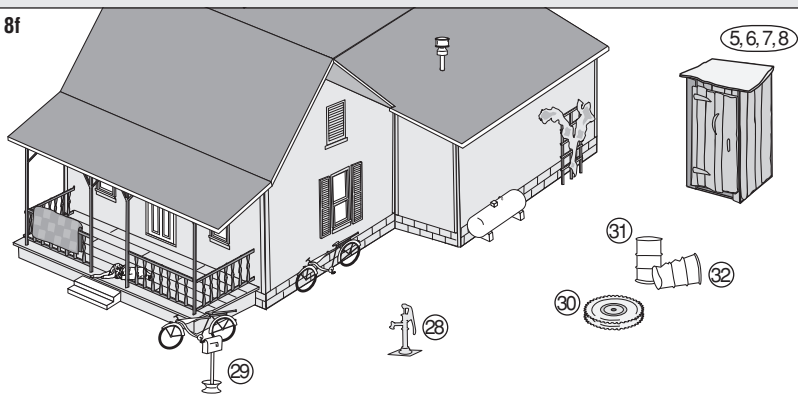

**Miscellaneous Parts** (Fig. 8f): Place where desired on layout. Assembled Outhouse (5,6,7,8), Water Pump (28), Mailbox (29), Old Tire (30), Trashcan (31), Smashed Trashcan (32)

## 9. Install Blackout Paper

- Cut a sheet of Blackout Paper, measuring 4 1/2" w x 1 1/8" h.
- Cut another sheet, measuring 5" w x 1 1/8" h.
- Lay the two sheets on top of each other and align them on one side. Make a mark in the center of the smaller sheet. On this mark, cut a notch half-way the two sheets (Fig. 9a).
- Assemble Blackout Paper as shown (Fig. 9b and 9c).
- Insert into Building (Fig. 9d).
- Place a drop of glue at each corner to hold in place.

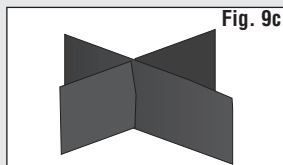
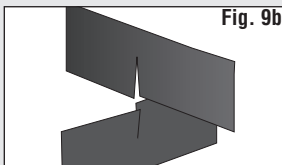
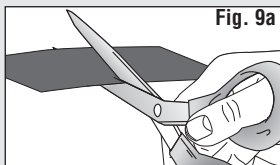
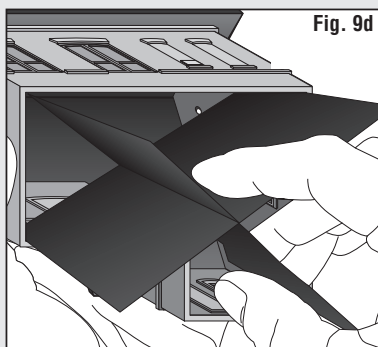

## Tips and Techniques

### Concrete Mortar

To add a realistic mortar-look to brickwork, apply a **Concrete Mortar Wash** (formula follows).

- Lay building flat so Wash will spread evenly. Using a paintbrush, dab on small amounts until desired look is achieved. Sponge off excess.

**Concrete Mortar Wash:** Mix together 1-part acrylic paint (color suggestion: Floquil® Polly Scale™ "Concrete" or "Aged Concrete"), 12-parts rubbing alcohol, 8-parts water and 1 drop liquid dish soap.

### Weathering

- **Airbrush:** Lightly spray thinned flat black paint (color suggestion: Floquil "Grimy Black") to areas where natural discoloration can occur (near windows, chimneys, etc.).
- **Chalk:** Rub a dark color of pastel chalk (color suggestion: gray, black, brown, etc.) on sandpaper to create a chalk dust. Using a paintbrush, dab chalk dust where discoloration can occur.