

PLASTER CLOTH - TRIPLE ROLL- C1192

INSTRUCTIONS

Use Plaster Cloth to create a durable, lightweight hard shell or terrain base that easily accepts coloring, plaster castings and other landscape materials. Use to fill gaps around rocks, tunnels and terrain seams. Apply Plaster Cloth over most surfaces, including No-News Paper™ (C1188), Foam Sheets (ST1422-ST1427), Shaper Sheet™ (C1178, C1179), newspaper wads and wire mesh.

- Cut Plaster Cloth into desired size strips.
- Fill the Plaster Cloth/Modeling Tray (C1194) or a pan with 1" of cold water. Dip and drag strip through water (**Fig. 1**). Do not let Cloth soak or it will lose plaster.
- Lay wet Plaster Cloth over desired surface, bumpy-side up (**Fig. 2**). Smooth plaster bumps with wet fingers to fill holes in cloth. Overlap previous sheet by 50% (**Fig. 3**). Repeat until project is covered.
- To model a hard-shell terrain, create paper wads with No-News Paper or newspaper. Roll edges of paper under, in a circular motion, creating a pillow shape (**Fig. 4**). Stack wads to form desired shape and hold in place with masking tape (**Fig. 5**). Apply Plaster Cloth over paper wads and let dry overnight, then add Woodland Scenics landscape materials.

NOTE: Do not wash excess plaster from pan of water down the drain.

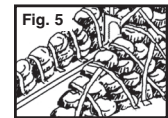
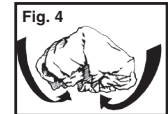
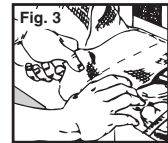
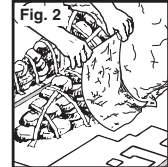
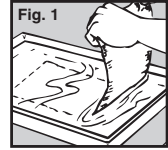

MODELING AND CARE INFORMATION: Clean up with warm, soapy water. Should product dry on clothing or work surface, rub with a soft, dry brush before washing.

This item is not a Children's Product and is not intended for use by Children.

Conforms to Health Requirements of ASTM D4236



CAUTION

We do not recommend using Plaster Cloth for body casts as it may irritate skin. Cutting tool recommended. Use with care.

Made in China F10 ©2013 O CO

WOODLAND SCENICS® PO Box 98, Linn Creek, MO 65052 • woodlandscenics.com