

INSTRUCTIONS / INSTRUCTIONS / INSTRUCCIONES / ANWEISUNGEN

SHAPER SHEET®

Basic Instructions / Instructions de base / Instrucciones básicas / Grundlegende Anweisungen

A. Without Plaster / Sans plâtre / Sin yeso / Ohne Gips

For a flexible, lightweight base. / Pour une base souple et légère. / Para una base flexible y liviana. / Für eine flexible, leichte Basis.

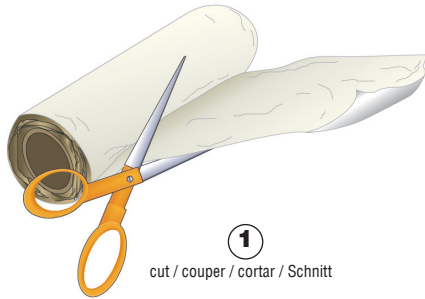

1

cut / couper / cortar / Schnitt

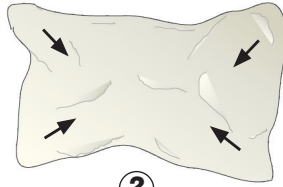

2

form / forme / formar / bilden

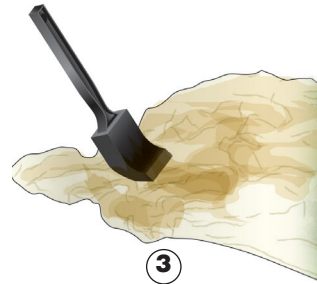

3

Earth Colors™ Liquid Pigment
(C1216-C1223, C1228-C1229)

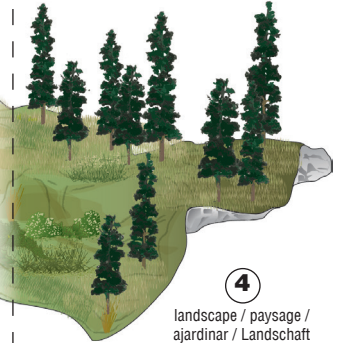

4

landscape / paysage /
ajardinar / Landschaft

B. With Plaster / Avec du plâtre / Con yeso / Mit Gips

For a hard, permanent terrain shell. Ideal for model railroads. / Pour une coque de terrain dure et permanente. Idéal pour les chemins de fer miniatures. / Para crear un caparazón de terreno duro y permanente. Ideal para ferrocarriles modelo. / Für eine harte, permanente Terrain-Shell. Ideal für Modelleisenbahnen.

1 cut / couper / cortar / Schnitt

2 form / forme / formar / bilden

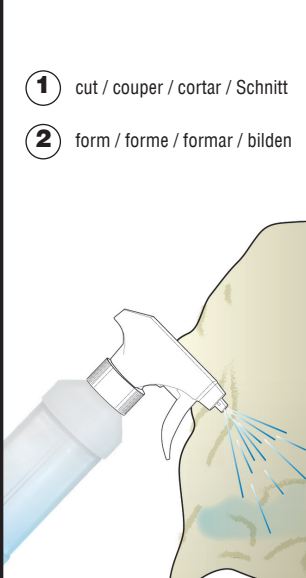

3

water / agua /
eau / Wasser

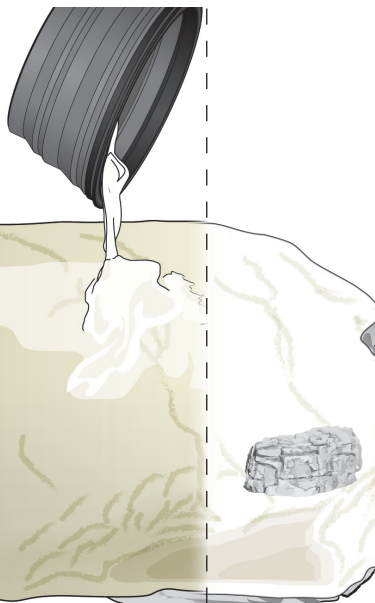

4

Shaper Sheet® Plaster (C1180),
Carving Plaster™ (C1198),
Super Strength Plaster™ (C1199),
Lightweight Hydrocal®* Plaster (C1201),
Mold-A-Scene™ Plaster (C1202)

5

Ready Rocks™
(C1136-C1142),
Rock Molds
(C1230-C1248)



6

Earth Colors Liquid Pigment
(C1216-C1223, C1228-C1229),
Water Undercoat™
(CW4530-CW4535)

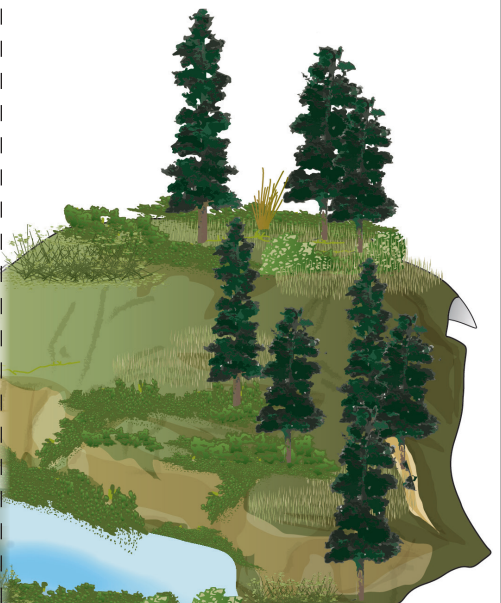

7

landscape / paysage /
ajardinar / Landschaft

*Hydrocal is a U.S. Gypsum registered trademark.

NOTE: Always coat Shaper Sheet with plaster to make water feature. / REMARQUE : enduisez toujours la Shaper Sheet de plâtre pour créer un élément d'eau. / NOTA: Siempre cubre la Shaper Sheet con yeso para hacer una característica de agua. / HINWEIS: Shaper Sheet immer mit Gips beschichten, um ein Wassermerkmal zu erhalten.

TIPS! / CONSEIL : / ¡CONSEJO! / TIPPS!

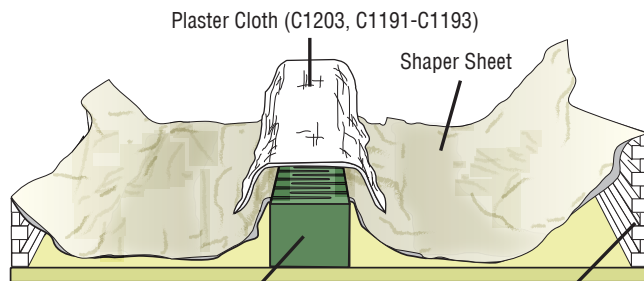

Plaster Cloth (C1203, C1191-C1193)

Shaper Sheet

Riser (ST1406-ST1409, ST1414),

Inclines / Declines (ST1410-ST1413, ST1415-ST1416)

Profile Board™
(ST1419)

Plaster Cloth will create a flat, smooth surface for train to run on. / La Plaster Cloth créer une surface plate et lisse sur laquelle le train pourra rouler. / Plaster Cloth creará una superficie plana y lisa para que el tren se ejecute. / Plaster Cloth erzeugt eine ebene, glatte Oberfläche, auf der der Zug laufen kann.

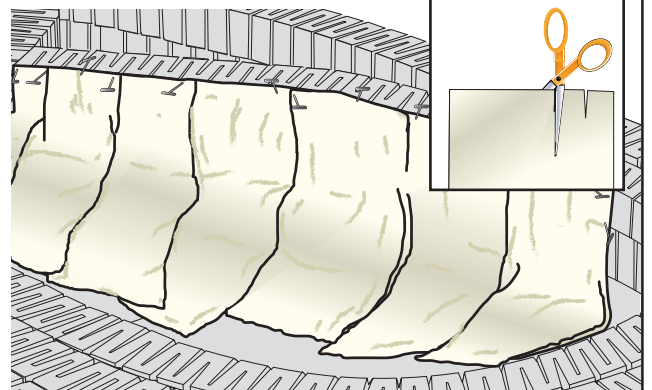

Notch or cut into strips for curves. / Encocher ou couper en bandes pour les courbes. / Muesca o corte en tiras para curvas. / Einkerbung oder in Streifen für Kurven schneiden.

OPTIONS / OPTIONS / OPCIONES / OPTIONEN

Expand / Étendre / Expandir / Erweitern

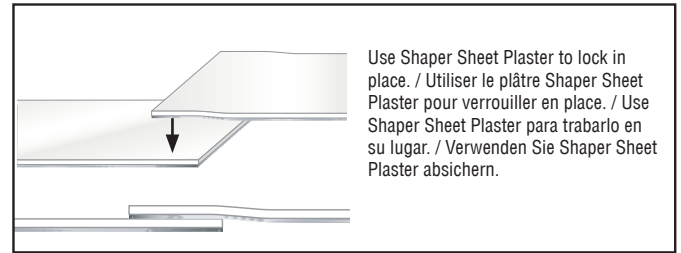
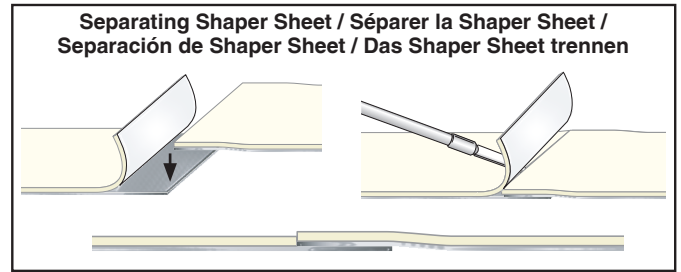
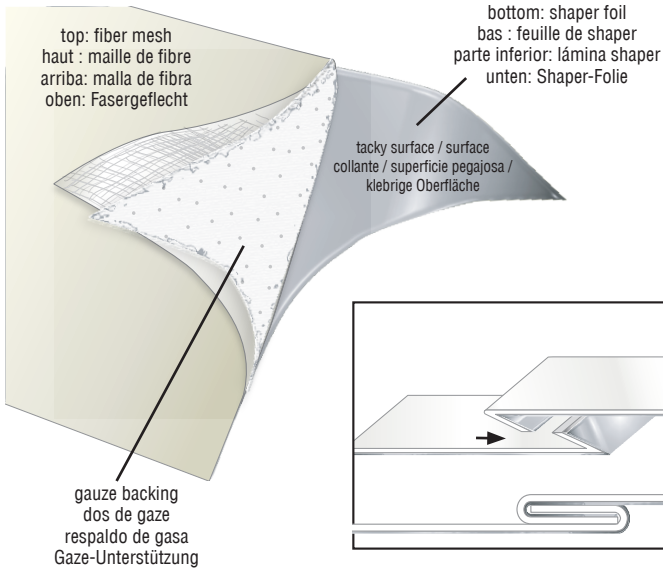

Fold edges under to strengthen. / Plier les bords sous pour renforcer. / Doble los bordes debajo para fortalecer. / Falten Sie die Kanten nach unten, um sie zu verstärken.

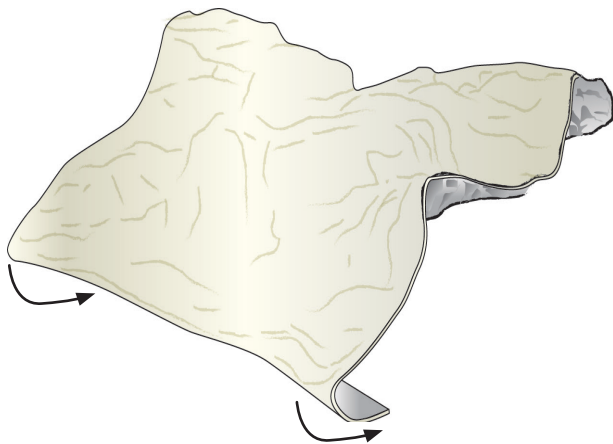

Using with Profile Boards / Utilisation avec des Profile Boards / Uso con Profile Boards / Verwendung mit Profile Boards

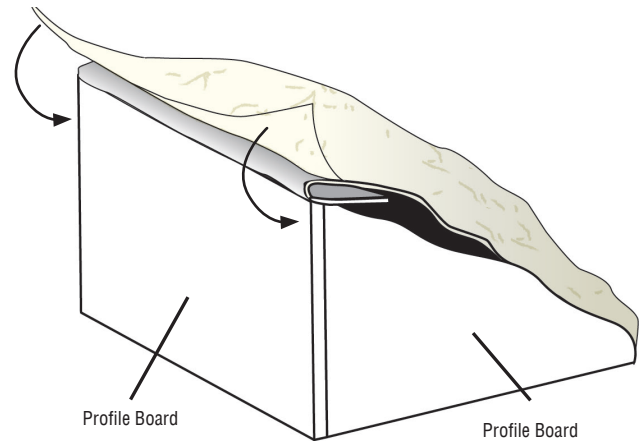

Along outer edges of Shaper Sheet, pull fiber mesh away from shaper foil approximately 1". Fold shaper foil under and press tacky surface onto edge of terrain profile. Cut away excess fiber mesh. / Le long des bords extérieurs de la Shaper Sheet, éloigner le treillis de fibre de la feuille de façonnage d'environ 2,54 cm. Plier la feuille en forme et appliquer le surface collante sur le bord du profil du terrain. Couper l'excès de maille de fibres. / A lo largo de los bordes exteriores de Shaper Sheet, retire la malla de fibra de la lámina de la Shaper aproximadamente 2,54 cm. Doble la lámina de la talladora por debajo y presione la superficie pegajosa en el borde del perfil del terreno. Corte el exceso de malla de fibra. / Entlang der Außenkanten von Shaper Sheet das Fasergeflecht ca. 2,54 cm von der Shaperfolie entfernen. Falten Sie die Shaperfolie unter und drücken Sie die klebrige Oberfläche auf die Kante des Terrainprofils. Überschüssiges Fasergeflecht wegschneiden.

EXAMPLES / EXEMPLES / EJEMPLOS / BEISPIELE

