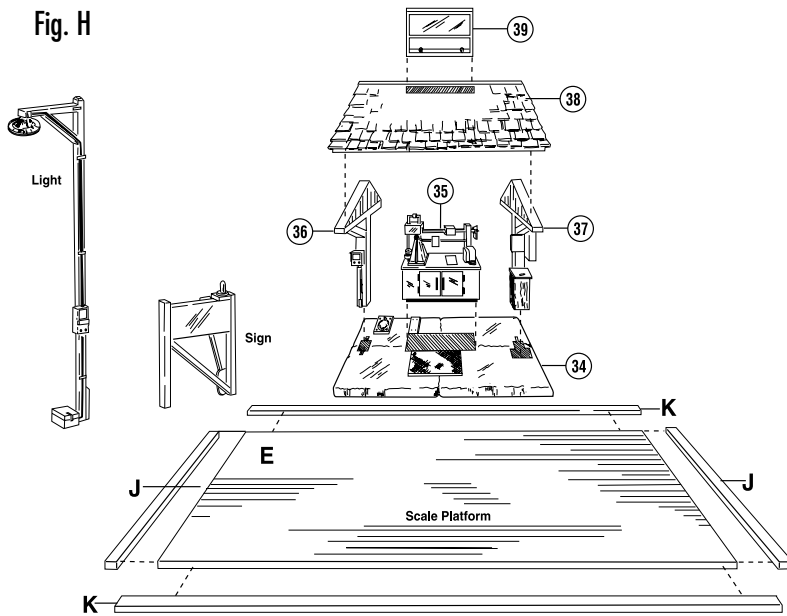

Fig. H



1. Assemble and glue Parts 34 and 35.
2. Butt Parts 36 and 37 up to flanges on Part 38 roof. Note: Roof should overhang Part 37 more than Part 36. Be sure Parts 36 and 37 are parallel to each other and perpendicular to Part 38 and glue.
3. Position and glue Parts 36 and 37 to Part 34.
4. Position and glue Part 39 to part 38.

SCALE PLATFORM

1. Glue basswood strips J & K to edges of basswood Part E. Trim excess wood.

FINAL ASSEMBLY

1. After all assemblies have been completed, glue them to the desired location on your mounting board or layout. Refer to instruction on Application of Base Turf and Ballast to landscape this trackside scene.
2. Pour coal into individual bins and hopper.
3. For realistic effects sprinkle small amounts of coal around hopper and bins, track, etc. to indicate spillage.

The many extra white metal castings are included to serve as added details to enhance your scene. Use your imagination. The variety of possible arrangements is what makes your particular scene unique.

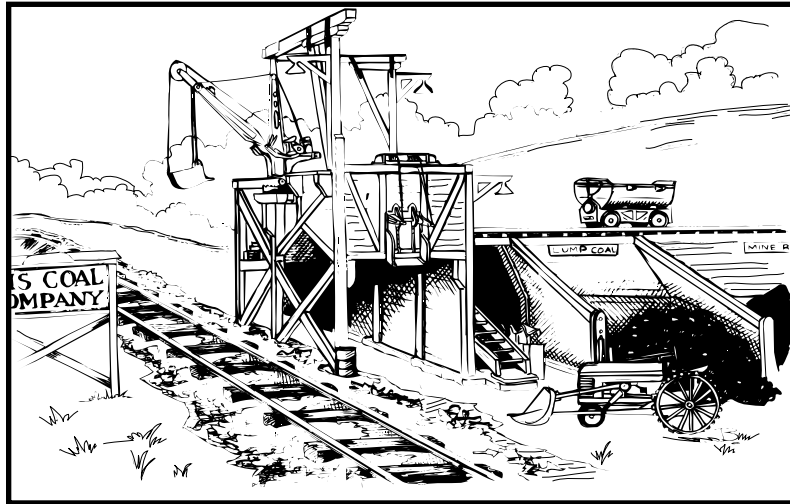

Otis Coal Company TS153

INTRODUCTION

(read entire instructions before starting)

Trackside Scenes, a series of highly-detailed and imaginative kits, are specifically designed to be easy to assemble. Please read all instructions through carefully before starting. Should you find any pieces defective, return defective part to Woodland Scenics for a replacement.

A COMPLETE LANDSCAPE SYSTEM

A system that allows virtually any size or species of tree, bush, ground cover, grass, soil or weed - a system that is specially designed to work within itself - means no longer do you have to search for compatible landscaping material. Woodland Scenics offers a complete system!

WOODLAND SCENICS BUYERS GUIDE

A fully illustrated booklet with color samples and illustrated examples of the most versatile landscape system available. Ask your local hobby shop for Woodland Scenics Catalog and see the entire line of Woodland Scenics products. If not available, send \$1.85 for current Catalog.

SCENERY MANUAL

The Scenery Manual has various tips, techniques, ideas and instructions for using more than 600 products. Anyone can make model scenery, and this manual will tell you and show you how.

To learn more tips and techniques, using Woodland Scenics products read *The Scenery Manual* (C1207), see the video or DVD, *Model Scenery Made Easy* (R993), or visit our Web site at www.woodlandscenics.com.

GENERAL INSTRUCTIONS

- A. Clean castings with dish soap and water. Rinse, test fit castings. The castings in this kit will have some parting lines, flash and stems that should be removed. They can be scraped off with a knife, filed off, or sanded. If castings don't align properly, fit them by removing metal with knife or file, as required. Except for trees the metal castings are somewhat brittle and should be handled carefully. If castings are bent or warped, straighten by placing on flat table and pushing down in high areas.
- B. Castings can be glued with white glue, fast setting epoxy or a cyanoacrylate such as "super glue." We prefer "super glue" because it is faster setting.
- C. We recommend that you finish your kit with Woodland Scenics Mini-Scene Paint Set (M125). Our paint set includes detailed instructions on painting and weathering. Other high-quality, flat hobby paints will work. Plan ahead. It is often easier to pre-paint certain castings. If you pre-paint castings, scrape paint from glue joints prior to assembly.

APPLICATION OF TURF AND BALLAST

Spray Scenic Cement (S191) in area you want turf. Sprinkle turf and re-spray with Scenic Cement to seal. Blend colors of turf for realism.

Apply Ballast to track. Brush off rail and ties. Spray with wet water (two drops of liquid detergent in one cup water). Use an eyedropper to soak Ballast with Scenic Cement.

APPLICATION OF DRY TRANSFER DECALS

Apply to clean, dry, dust-free area. Lay Dry Transfer Decal on desired area. Place backing sheet over decal and rub with dull pencil or burnisher. For best transfer, place backing sheet over decal and rub again. Press well in crevices and corners while transferring. NOTE: If sign is applied in recessed area, cut to fit the area and take care not to move sheet while burnishing.

KIT COMPONENTS

Over 80 Castings Including:

- | | |
|---------------------|------------------------------|
| Dry Transfer Decals | Coal Bunker Assembly |
| 2 Sheets Basswood | Scale Assembly |
| 24" Elastic String | Tractor With Shovel Assembly |
| 2 12" Wires | Crane Assembly |
| Foliage | Track Car Assembly |
| 2 Colors Turf | Signs |
| Ballast | Lights |
| 2 Types of Coal | Barrels |
| | Shovels |
| | Ladders |

WOODLAND SCENICS®
 P.O. Box 98 • Linn Creek, MO 65052
 Phone 573-346-5555 • Fax 573-346-3768
www.woodlandscenics.com

INSTRUCTION SEQUENCE

COAL BUNKER - FIG. A & B

1. Clean and fit all castings.
2. Align and assemble Parts 1 thru 7 (Fig. A) (NOTE: Parts 1 & 2 and 3 & 4 overlap).
3. Cut all basswood pieces to size with X-acto knife or razor blade. NOTE: Count strips for correct line (Fig. B).
4. Trim and notch basswood Part F to size and glue.
5. Glue 1 each of Parts 8 and 9 to assembly as shown (Fig. A).

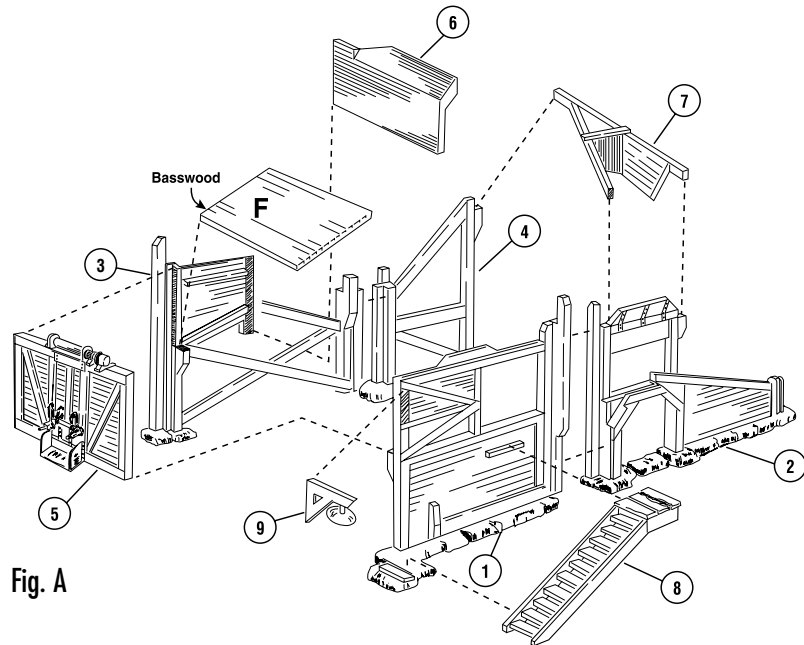

Fig. A

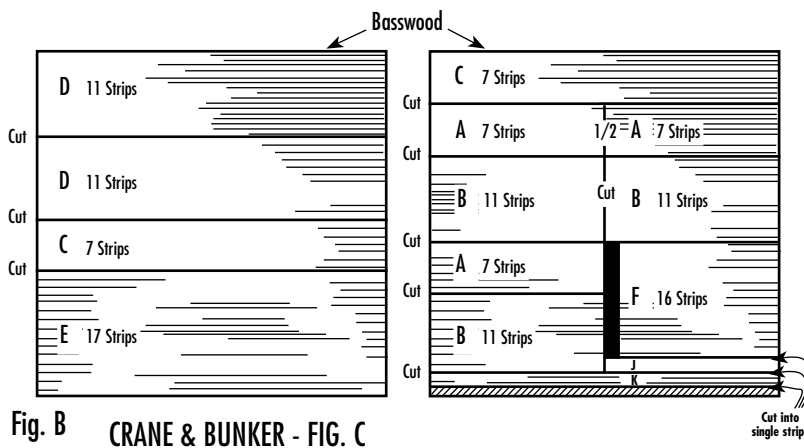
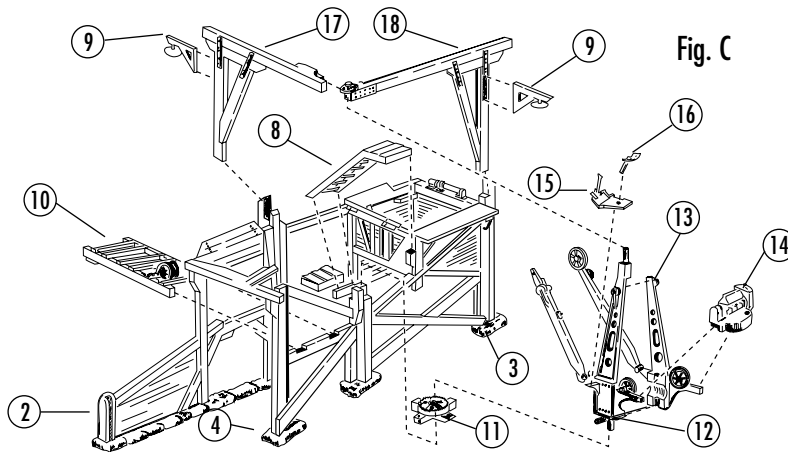
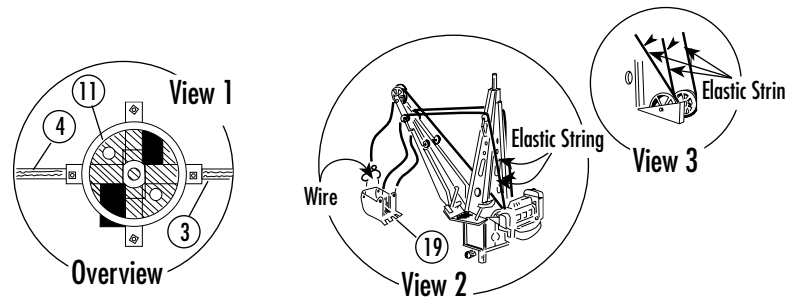

Fig. B CRANE & BUNKER - FIG. C



1. Attach Parts 8, 10 and 11 to assembly (Note: See View 1 Fig. C to determine proper placement of Part 11).
2. Assemble and glue Parts 12 thru 16 in numerical sequence.
3. Attach elastic string (Views 2 and 3, Fig. C).
4. Make wire support for bucket, Part 19 (View 2, Fig. C). Attach wire support to bucket.
5. Glue elastic string to bucket, Part 19, as shown.
6. Assemble and glue Parts 17, 18 and crane assembly in proper position. NOTE: If rotating crane is desired, be careful to keep glue off pin on crane.
7. Attach (2) Parts 9 to assembly as shown.



COAL BINS - FIG. D & E

1. Assemble and glue (4) Parts 19 and (2) Parts 20 to basswood walls. A thru D as shown in Fig. D. NOTE: Pay careful attention to the difference in Parts 19 and Parts 20 (Fig. E). Assemble in progression from left to right placing edge of each basswood section on outside of support ridge of each cast wall section. NOTE: Keep assembly straight because track sections will be laid down on top of it.
2. Connect bin assembly to tower assembly by gluing basswood walls A & B from Part 19 to Part 2.
3. Assemble and glue track sections (3) Parts 21 and 22 to top of bin assembly. Begin at Part 2. NOTE: Track sections may be too long. File track sections when necessary to butt together in center of supports.
4. Glue Part 23 to Part 22.

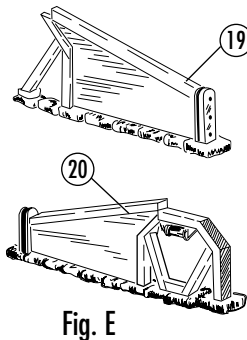

Fig. E

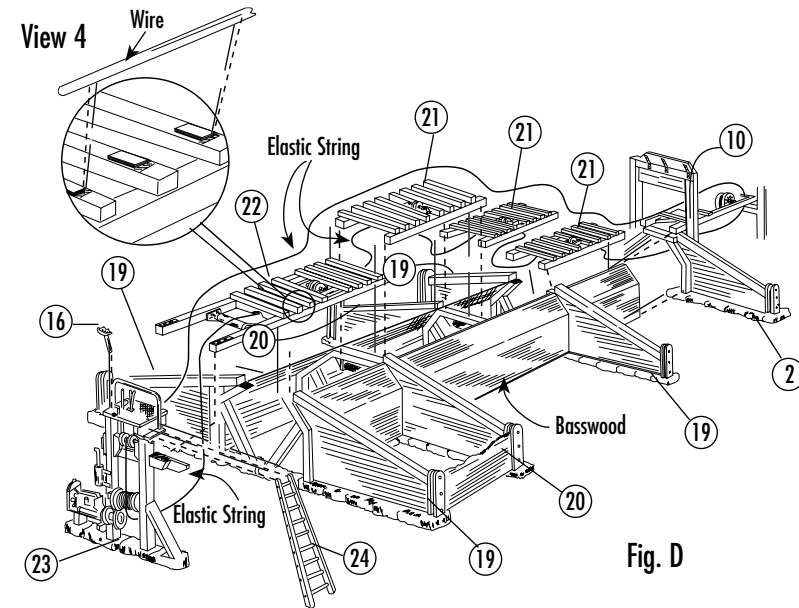

Fig. D

5. Glue Parts 24 and 16 to Part 23.
6. Attach elastic string from bottom pulley of Part 23 under track, around pulley on Part 10, over pulleys on Parts 21 thru 22, over top pulley on Part 23 and return to bottom pulley as shown.
7. Attach wire to track sections (3 Parts 21 and Part 22) as shown in view 4. Do not extend wire rail beyond the tracks end.

CAR - FIG. F

1. Glue both Parts 27 together.
2. Glue Part 26 to Parts 27.
3. Place or glue on track in desired location.

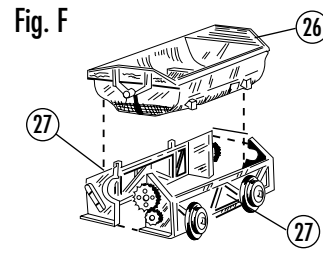

Fig. F

TRACTOR - FIG. G

1. Glue Parts 28 thru 30 in numerical sequence.
2. Glue (2) Parts 31 and Part 32 together as shown, keep Parts 31 parallel.
3. Glue shovel assembly to tractor (Fig. G).
4. Cut length of wire approximately 7/8" for steering column, glue to Parts 28 and 33.

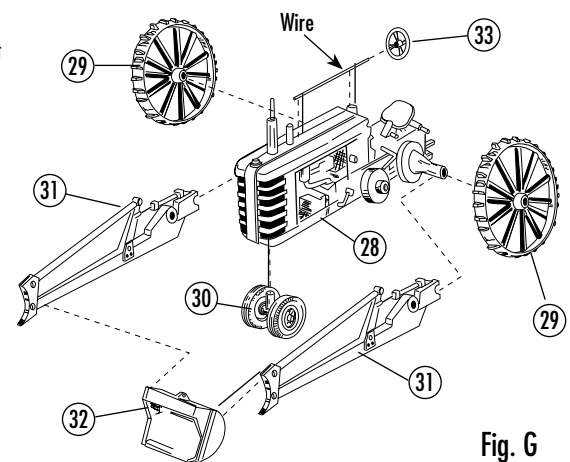

Fig. G

SCALE - FIG. H