

Possum Hollow

TS151

INTRODUCTION

(read entire instructions before starting)

Trackside Scenes, a series of highly-detailed and imaginative kits specifically designed to be easy to assemble. Please read all the instructions through carefully before starting. Should you find any defective pieces, simply return defective part to Woodland Scenics for a replacement.

GENERAL INSTRUCTIONS

- Clean and fit castings. The castings in this kit will have some parting lines, flash and stems that should be removed. They can be scraped off with a knife, filed off, or sanded. If castings don't align properly, fit them by removing metal with knife or file, as required. Except for trees the metal castings are somewhat brittle and should be handled carefully. If castings are bent or warped, straighten by placing on flat table and pushing down in high areas. All castings should be washed in soapy water and rinsed prior to gluing or painting.
- Gluing of castings. Castings can be glued together with white glue, fast setting epoxy or a cyanoacrylate such as "super glue." (We prefer "super glue" because it is faster setting.)
- Paint castings. We recommend that you finish your kit with Woodland Scenics Mini-Scene Paint Set (M125). Our paint set includes detailed instructions on painting and weathering. Other high quality flat hobby paints will work. Plan ahead. It is often easier to pre-paint certain castings. If you pre-paint castings, scrape paint from glue points prior to assembly.

APPLICATION OF TURF

- Locate exact position desired for model on your layout or mounting board. If area is glossy or slick, lightly sand. If it is covered by grass mat, remove mat and lightly sand exposed area.
- Spray entire area with Scenic Cement (S191). Sprinkle turf into wet glue until completely covered. Allow to dry.
- Brush with a soft brush or gently blow excess turf onto a piece of paper and save.
- Blend or mix colors of turf until it looks natural, (one area of only one color seldom occurs in nature). If additional blending is needed, spray with Scenic Cement and apply more turf. Make sure to blend turf from this kit with surrounding areas of existing scenes. Feather or blend all edges together with edges of existing layout.
- If you do get too much of one color in any particular area (use "spray" technique as mentioned in number 4). Also, it may be desired to leave some areas "bald" (with "dirt" showing) to show wear or activity.
- When desired coloration is accomplished, further secure by lightly spraying surface of entire area as in step 4.

TREE CONSTRUCTION

Preparing The Tree Armature

- Remove any possible "flashing" from tree. Wash trees with soap and water, then let dry.
- Bend tree to a realistic, three-dimensional shape. You may want to cut or break some branches for more variety.
- Brush or spray-paint tree with any flat lacquer, enamel, or acrylic paint (for acrylic paints you must first use a primer).
- Most trees are dark with light or medium brown highlights. After paint dries, lightly dry-brush lighter or darker color for even more realism.

Application of Foliage

- Stretch Foliage to desired density, cut material in places to create open areas (if desired).
- Place stretched Foliage on branches of tree. If you don't obtain full coverage, stretch Foliage even more. Glue to branches, if desired.
- Trim unwanted strands of Foliage with scissors. Spray tree lightly with Scenic Cement one last time to set Foliage.
- Extra Foliage may be used as bushes or weeds.

NOTE: Be creative, the possibilities are endless!

KIT COMPONENTS

Instruction

Cardstock
Wooden Ties
Wire
Acetate For Windows
2 Colors Foliage
2 Colors Turf
2 Colors Foliage
2 Colors Turf

Over 80 Castings Including:

Lots of Junk Piles
Caboose Assembly
Outhouse Assembly
Fuel Tank Assembly
Laundry
Washing Machine
Refrigerator
Tanks
Wood Pile
Man and Woman
2 Dogs

A COMPLETE LANDSCAPE SYSTEM

A system that allows virtually any size or species of tree, bush, ground cover, grass, soil or weed - a system that is specially designed to work within itself - means no longer do you have to search for compatible landscaping material. Woodland Scenics offers a complete system!

WOODLAND SCENICS BUYERS GUIDE

A fully illustrated booklet with color samples and illustrated examples of the most versatile landscape system available. Ask your local hobby shop for Woodland Scenics Buyers Guide and see the entire line of Woodland Scenics products. If not available, send \$1.85 for current Buyers Guide.

SCENERY MANUAL

The Scenery Manual has various tips, techniques, ideas and instructions for using more than 600 products. Anyone can make model scenery and this manual will tell you and show you how.

To Learn more tips and techniques, using Woodland Scenics products read *The Scenery Manual (C1207)*, or visit our Web site at www.woodlandscenics.com.

WOODLAND SCENICS®

P.O. Box 98 • Linn Creek, MO 65052
Phone 573-346-5555 • Fax 573-346-3768
www.woodlandscenics.com

INSTRUCTION SEQUENCE

CABOOSE FIG. A

1. Clean and fit castings.
2. Measure the back side of each window opening, cut acetate to size. Glue acetate in place behind window opening after walls are painted.
3. Assemble and glue Parts 1 thru 4 in numerical sequence. NOTE: Keep top edge of all parts flush. Allow to dry.
4. Glue both Parts 6 to assembly (1 thru 4). NOTE: Top edge of Parts 6 must be flush with tops of Parts 1 thru 3.
5. Assemble and glue Parts 7 thru 9 to assembly as shown in Fig. A.
6. Assemble caboose supports using 10 wood ties and glue. Fig. A.
7. Cut floor from cardstock to fit ridge inside caboose and glue.
8. Glue assembled caboose supports to cardstock floor.
9. Glue details 10 thru 14 to assembly. NOTE: Part 14 fits under bottom of caboose.
10. Glue both Parts 5 to 7 as shown.

Fig. A

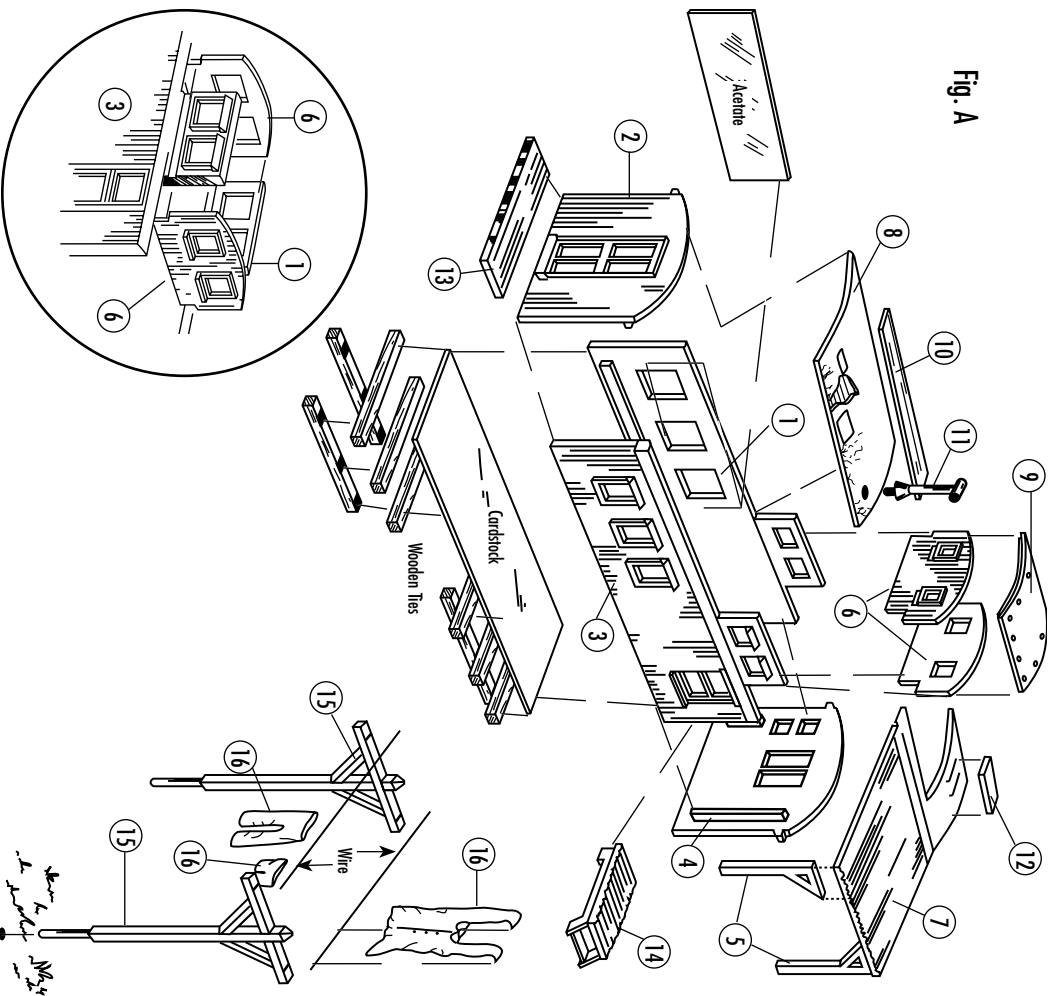

CLOTHESLINE

1. Permanently attach clothesline poles to mounting board or landscape. This can be done by drilling 2 small holes (approximately 2 1/4" apart) and placing clothesline poles into holes until pin is covered.
2. Making sure the poles face each other, glue 2 equal lengths of wire to crossbars (one each side, allow to dry).
3. Glue pre-painted clothing, Parts 16, to clothesline as shown.

OUTHOUSE FIG. B

1. Lay Parts 17 and 18 on a sheet of sandpaper with inner seam down. Move parts with a stroking motion on sandpaper until the edge is straight and smooth.
2. Assemble and glue Parts 17 and 18. Allow to dry.
3. Turn the outhouse, Parts 17 and 18, upside down on sandpaper and sand the top edge smooth (as described above).
4. Assemble and glue Part 19, roof, to assembly 17 and 18.

FUEL STAND FIG. C

1. Assemble and glue Parts 20 thru 24 together in numerical sequence.

Fig. B

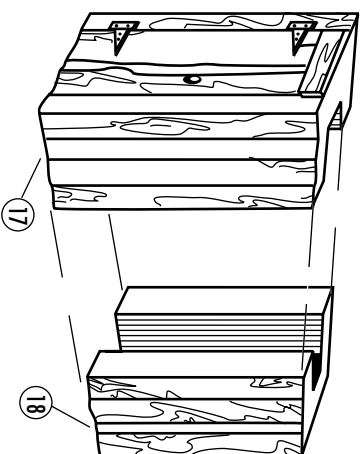
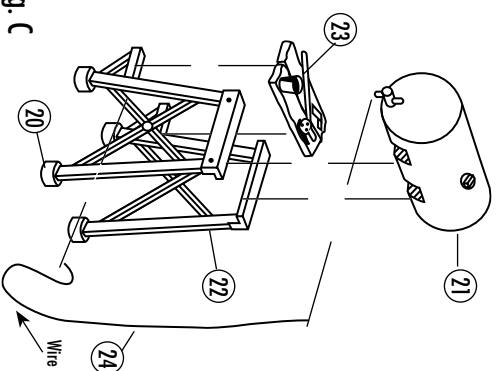

Fig. C



FINAL ASSEMBLY

After all assemblies have been completed, glue them to the desired location on your mounting board or layout. Refer to instructions on application of Turf to landscape this Trackside Scene.

The extra white metal castings are included to serve as added details to enhance your scene.

Use your imagination, the variety of possible arrangements is what makes your particular scene unique.