

#507 Corner Apothecary

INSTRUCTIONS

Please read through all instruction first. Use plastic model cement or solvent to adhere parts, but avoid contact with detail. Allow glue to dry thoroughly before next step. Cut off – do not break – and file "gates" (areas where plastic enters the parts).

Sand Draft Angles: Remove draft angle (angled edges) from the right edge (second and third floors only) of the short front wall (507-1), from the right edge of the rear wall (507-4) and from both edges of the end wall (507-3). Square the edges marked "A" (Fig. 1), by thumbtacking a piece of 150 grit sandpaper to a board and pushing and pulling the part back and forth (Fig. 2).

Wall Assembly: Glue the front walls (507-1 and 507-2) first. Line up the brick courses and hold in place with rubber bands, making sure the corners are square and the bottoms of the walls are flush. Allow glue to dry thoroughly. Glue the long back wall (507-4) to the short front wall (507-1). The remaining wall (507-3) may need some minor sanding to square the building. Wall (507-3) should be trimmed on either or both edges. Glue when satisfied with the fit and use rubber bands to keep the building square while it dries.

Cornice: Cornice (507-5) fits into the slots located near the tops of the walls (507-1 and 507-2). The slot on the right edge of wall (507-2) will have to be altered with a hobby knife to match the profile of the adjacent slot on wall (507-1).

Corner Door (507-7): Lightly sand the door's tapered edges to fit and glue in place.

Cut and Paint Roof: Measure and cut to size. Paint with a black acrylic paint and set aside to dry.

Chimney Backs: Lightly sand chimney backs (507-6) and glue in place.

Leveling: Sand the bottom of the building in a circular motion to level all bottom edges.

Painting: Use acrylic paints to airbrush the buildings. We recommend

(instructions continued on back)

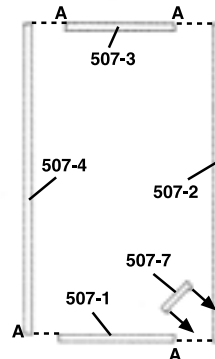

Fig. 1
Plan (View from Top)

Fig. 2
Sand edges square.

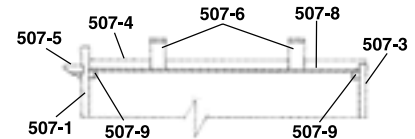
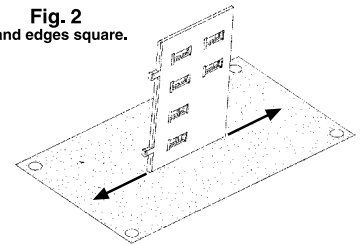

Fig. 3
Cross Section

DRAWINGS NOT
TO SCALE

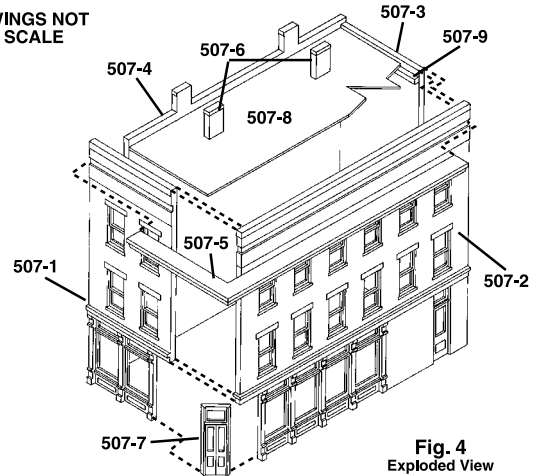

Fig. 4
Exploded View



Corner Apothecary
#507
Scale Model Material

N SCALE

(instructions continued)

over-spraying the whole building with a light, uneven coat of black acrylic to give it a weathered look. Allow paint to dry.

Windows: Cut the window material to size and install over the entire area of window openings.

Roof Installation: The roof (507-8) will be glued to the bottoms of the two chimney backs (507-6). Once the roof is glued to the chimney backs, cut and glue roof support strips (507-9) around walls (Fig. 3). Glue roof to roof supports.

Finishing: Place a piece of black construction paper diagonally inside, from corner to corner, to give the illusion that the building is being occupied.

The Corner Apothecary is an example of commercial American Victorian architecture from Main Street, Anytown, USA. This beautiful and ornate style dominated building design during the latter half of the Nineteenth Century.



N SCALE
STRUCTURE KIT



Vehicles, figures, & decals not included.

#507
CORNER
APOTHECARY
3 3/8"W x 1 3/8"D x 3"H



7 81324 00507 g

Design Preservation Models
P.O. Box 66, Linn Creek, MO 65052
www.dpmkits.com

MADE IN USA U5 ©1996 OCO