

LANDMARK STRUCTURES®

N SCALE
1:160
BUILDING KIT

SICKEN TIRE COMPANY PF5204

Model the center of a busy industrial park. Sicken Tire Company is in full production, working to meet the expanding demand for one of humanity's greatest inventions. Whitewalls, studded snows and retreads roll out by the hundreds.

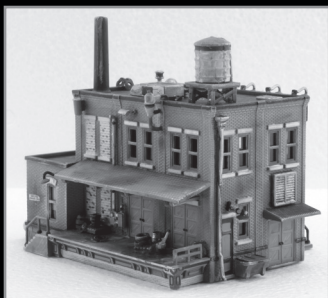

MODELING AND CARE INFORMATION

This kit suggests the use of materials that may stain or cause damage. Take care to cover project area and clothing appropriately. Follow recommendations for use and cleanup.

CAUTION: Cutting tools recommended. Use with care.

We make every effort to ensure our kits are manufactured complete. However, if this kit is missing a part, please make note of the kit name, number and missing part. Contact the Sales and Customer Service Department at PO Box 98, Linn Creek, MO 65052, 573-346-5555 or sales@woodlandscenics.com.



WOODLAND SCENICS®

XPF5204INST M10 ©2016 O CO

SICKEN TIRE COMPANY

Building Kit Contents

- Main Building
- Building Add-On
- Sprues with Details
- Pre-printed Window Material
- Clear Window Material
- Dry Transfer Decals
- Blackout Paper

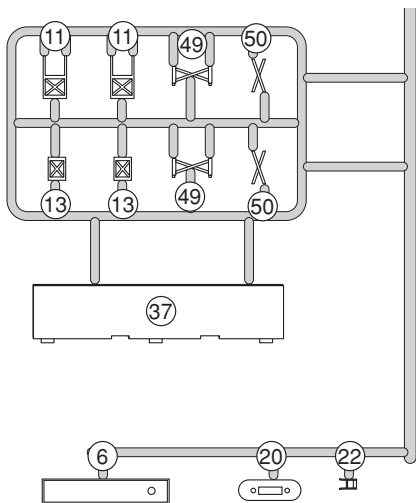
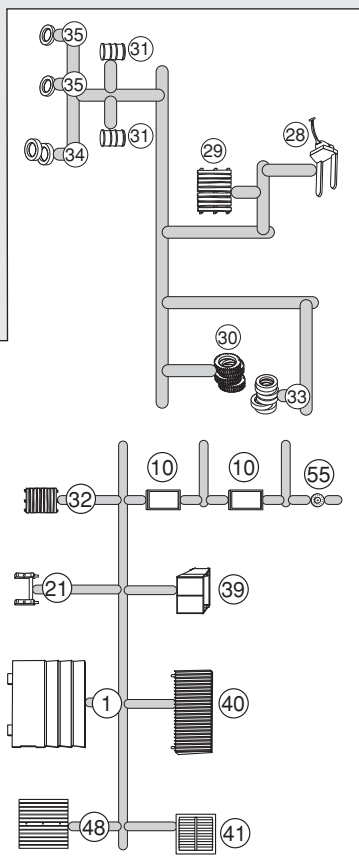
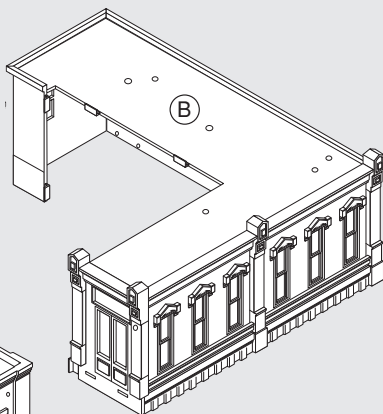
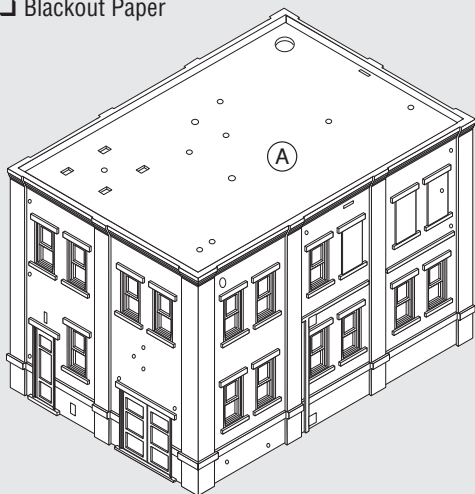

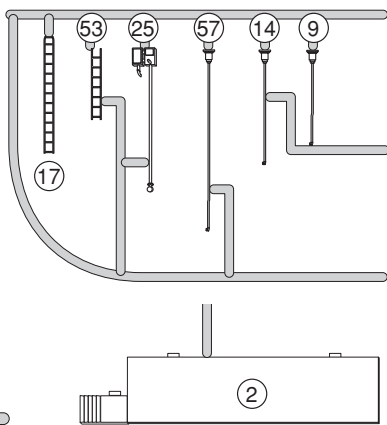
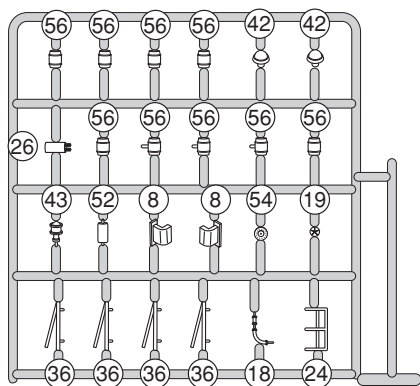
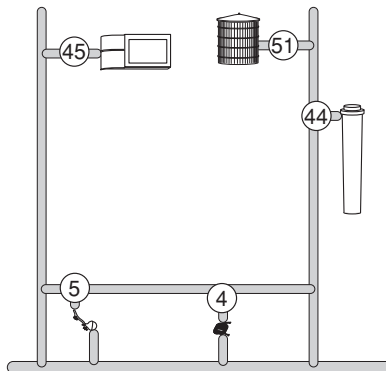
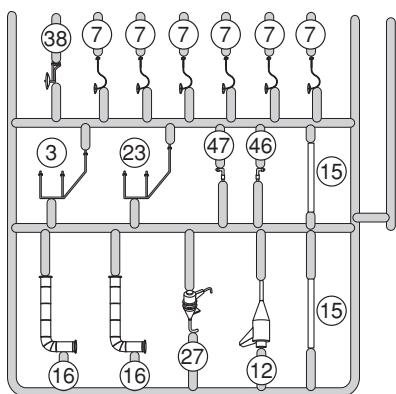

Before You Begin

- Read through instructions.
- Collect additional supplies.
- Check kit contents and verify Details.
- Cover project area with newspaper.

TIP! To assist in assembly, refer to exploded-view illustration on back of box.

Additional Needed Supplies

- | | |
|--|--|
| <input type="checkbox"/> Solvent-based Plastic Cement* | <input type="checkbox"/> Fine grade Sandpaper |
| <input type="checkbox"/> Cyanoacrylate Adhesive (CA glue / super glue) | <input type="checkbox"/> Tweezers |
| <input type="checkbox"/> Paints (acrylic or enamel)* | <input type="checkbox"/> Scissors |
| <input type="checkbox"/> Primer* | <input type="checkbox"/> Ruler |
| <input type="checkbox"/> Painting Tools | <input type="checkbox"/> Newspaper |
| <input type="checkbox"/> Hobby Knife / Flush Cutting Shears | <input type="checkbox"/> Burnisher / Dull Pencil |

NOTE: Plastic cement works by dissolving the surface of plastic and welding parts together. Avoid contact with detail on parts. Always allow glue to set before moving to the next step.

*Contact your local hobby shop for recommendations.

1. Building and Detail Preparation

- Remove any mold flash from Buildings (A, B) using a hobby knife and sandpaper.
- Using a hobby knife (or flush cutting shears), remove angled portion only from the six “L” brackets on Building Add-on (B) (Fig. 1a).
- Wash Buildings and Details (on sprue) in warm, soapy water. Rinse and let dry.
- Remove Details from sprue with a hobby knife (or flush cutting shears) (Fig. 1b).

NOTE: Do not remove Placement Posts from Details (Fig. 1c).

- Sand off any mold flash and parting lines from Details.

NOTE: Do not sand Placement Posts.

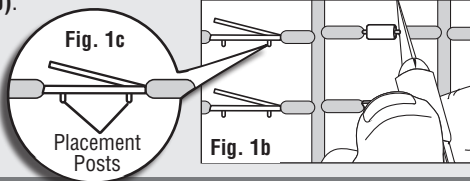
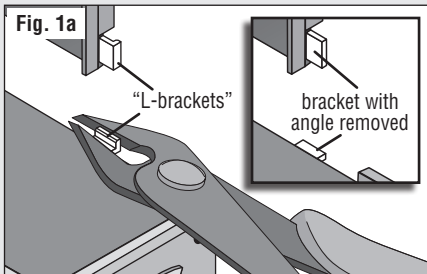

2. Prime and Paint

NOTE: Do not prime or paint Placement Posts.

- Apply a thin coat of primer to Buildings and Details.
- Let dry.
- Paint Building and Details as desired.
- Let dry.

OPTION: Add a realistic mortar-look to brickwork (see Tips and Techniques, page 6).

TIP! To make priming and painting easier, attach Details (unexposed side down) to loops of masking tape on a piece of cardboard (Fig. 2a and 2b).

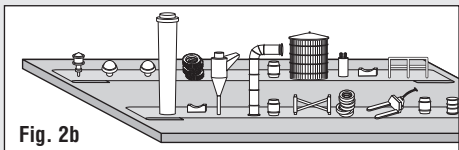
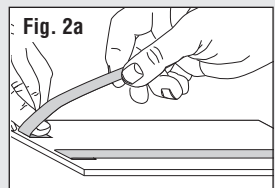

3. Assemble Building

- At an angle, insert back corner tabs on Building Add-On (B) into placement notches on backside of Main Building (A) (Fig. 3a).
- Rotate Building Add-On around and align tabs on right side of Building Add-On with notches in right side of Main Building.
- While holding Entry Stairs (1) in place, finish rotating Building Add-On and align final set of tabs in notches.
- Apply glue along inside seams and tabs on interior of Building.

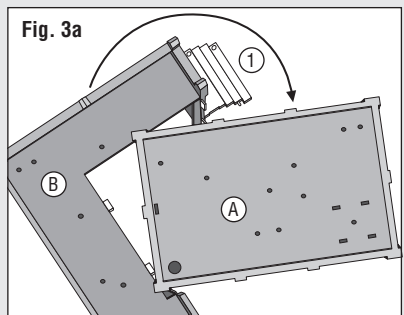

4. Attach Dock

- Align tabs on Dock (2) with placement notches on Back Wall of Main Building, then press into place (Fig. 4a).
- Apply glue along inside seams and tabs.



5. Install Window Material

Remove protective film before installation.

- **Prepare and Install Window Material for Entry Door (Fig. 5a):** Cut a rectangular piece of Clear Window Material 1/2" x 7/8". Test fit over Entry Door on inside of Building Add-On. Mark location for **OFFICES** Decal, and then apply. (See Step 6 for Dry Transfer Decal instructions.) Place over Entry Door on inside of Building and glue in place.
- Place Building on its front face with the bottom toward you (Fig. 5b).
- Position printed side of Pre-printed Window Material toward inside of Building and center over window.
- Carefully dab a small amount of glue around edges of Pre-printed Window Material (Fig. 5b).
- Repeat for each set of window openings.

TIP! If clear window treatments are preferred, use Clear Window Material.

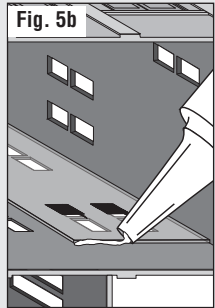

6. Apply Dry Transfer Decals

- Cut out desired Decal, leaving a slight edge (Fig. 6a). Grasp edge of Decal with tweezers and avoid handling the back.
- Position in desired location and rub over entire Decal area with a burnisher or dull pencil (Fig. 6b).
- Carefully lift away carrier sheet. If Decal did not transfer completely, let carrier sheet fall back in place and burnish again.
- Place backing paper over Decal and rub again for maximum adhesion.

NOTE: To be sure signs are not upside down, test fit Decals on signs before applying.

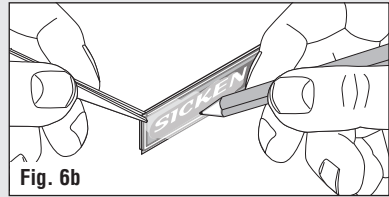
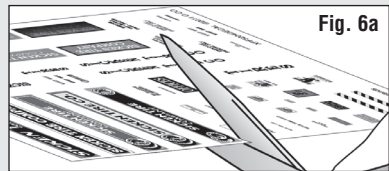

7. Preassembly

Assemble and glue the following Detail pieces.

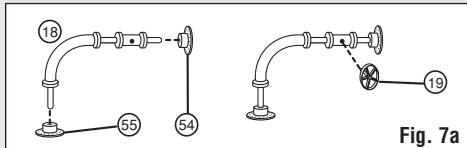

Water Pipe (Fig. 7a)

Glue Water Pipe Top End (54) and Bottom End (55) to Water Pipe (18) and attach Water Pipe Valve (19).

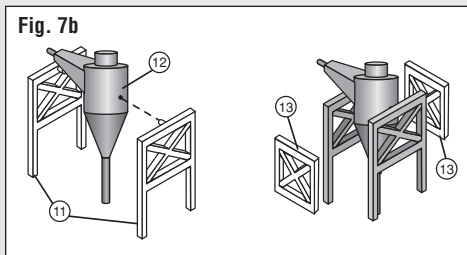

Dust Collector (Fig. 7b)

Glue Large Dust Collector Frames 2x (11) to Dust Collector (12). Glue Side Frames 2x (13) to Dust Collector.

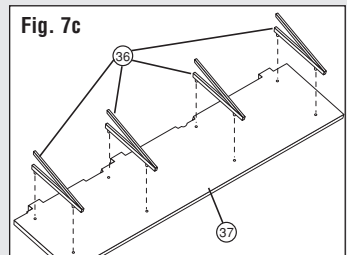

Dock Awning (Fig. 7c)

Glue Awning Supports 4x (36) to Dock Awning (37).

7. Preassembly cont.

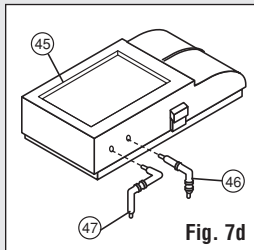

Fig. 7d

A/C Unit (Fig. 7d)

Glue A/C Elbow Pipe (46) and Double-elbow Pipe (47) to A/C Unit (45).

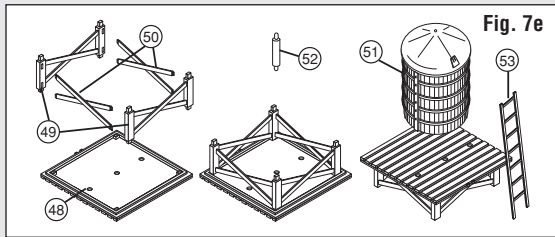

Fig. 7e

Water Tower (Fig. 7e)

Glue Water Tower Base (48), Supports with Posts 2x (49) and Side Supports 2x (50). Glue Water Pipe (52) to Water Tower Base Assembly. Glue Water Tower (51) to Water Tower Base Assembly. Glue Water Tower Ladder (53) to Water Tower Assembly.

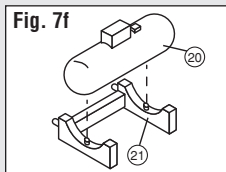

Fig. 7f

Propane Tank (Fig. 7f)

Glue Propane Tank (20) to Propane Tank Stand (21).

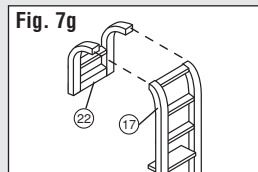

Fig. 7g

Ladder (Fig. 7g)

Glue Top Ladder Section (22) to Ladder (17).

8. Install Details

To install Details, apply a tiny amount of glue on placement post, and then align post in placement hole. Use tweezers to make installation easier.

Place extra Details (Barrels 9x (56)) as desired or use them for another project.

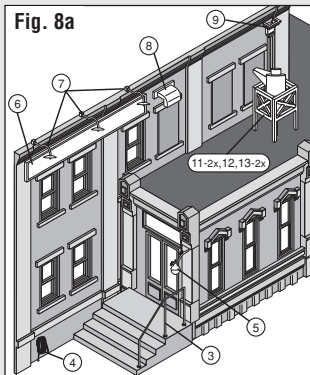

Fig. 8a

Front (Fig. 8a)

Front Stair Railing (3), Hose (4), Globe Light (5), Front Sign (6), Light 3x (7), Exhaust Hood (8), Short Downspout (9), Dust Collector Assembly (11, 12, 13)

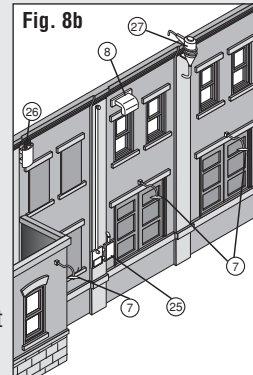

Fig. 8b

Back (Fig. 8b)

Electric Meter and Junction Box (25), Transformer (26), Exhaust Hood (8), Small Dust Collector (27), Light 3x (7)

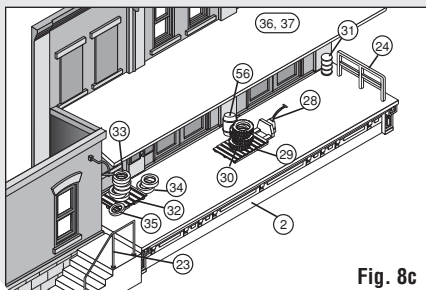

Fig. 8c

Dock Details (Fig. 8c)

Back Steps Railing (23), Dock Railing (24), Pallet Jack (28), Pallet (29), Short Set of Tires (30), Trash Barrels 2x (31), Small Pallet (32), Tall Set of Tires (33), Double Tires (34), Single Tire 2x (35)
NOTE: Use placement holes on Dock as a placement guide for Details.

Dock Awning (Fig. 8c)

Glue Dock Awning Assembly (36, 37) to Back Wall.

8. Install Details cont.

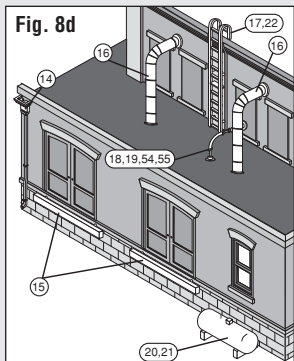

Right Side (Fig. 8d)

Medium Downspout (14), Dock Bumpers 2x (15), Pipes 2x (16), Ladder Assembly (17, 22), Water Pipe Assembly (18, 19, 54, 55), Propane Tank Assembly (20, 21)

Left Side (Fig. 8e)

Long Downspout (57), Backdoor Light (38), Dumpster (39), Small Awning (40), Wall Vent (41)

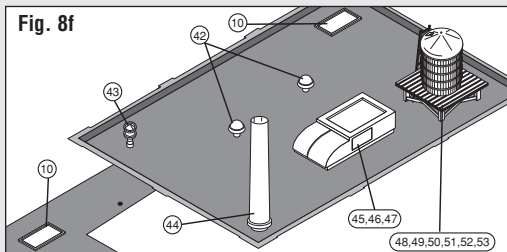
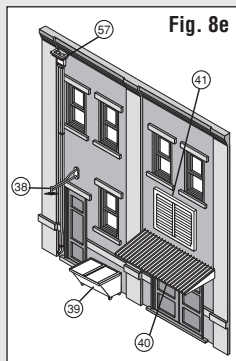

Roof (Fig. 8f)

Roof Hatch 2x (10), Large Roof Vent 2x (42), Small Roof Vent (43), Smoke Stack (44), A/C Unit Assembly (45, 46, 47), Water Tower Assembly (48, 49, 50, 51, 52, 53)

9. Install Blackout Paper

- Cut two sheets of Blackout Paper: each measuring 3 1/4" W x 1 3/4" H
- Cut another two sheets of Blackout Paper: each measuring 2 1/2" W x 3/4" H
- Lay equal size sheets on top of each other, then cut a notch halfway up the paper (Fig. 9a).
- Assemble Blackout Paper as shown (Fig. 9b).
- Insert into Buildings (Fig. 9c).
- Place a drop of glue at each corner of Blackout Paper to hold in place.

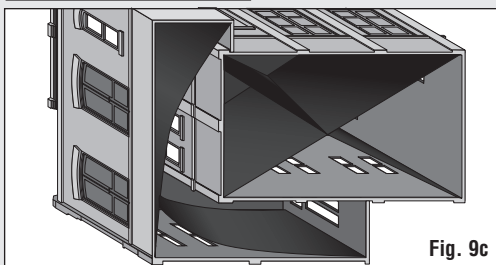
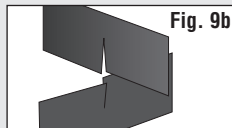
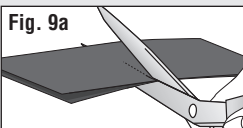

Tips and Techniques

Concrete Mortar

- To add a realistic mortar-look, apply a **Concrete Mortar Wash** to brickwork (formula below). Lay building flat so the wash will spread evenly. Avoid Decals and dab on small amounts of Mortar Wash until desired look is achieved. Sponge off excess.

Concrete Mortar Wash: 1-part paint (color suggestion: concrete, aged concrete, etc.), 9-parts rubbing alcohol, 7-parts water, 2-drops liquid dish soap

Weathering Techniques

- Age decals by scoring and chipping with a hobby knife.
- **Airbrush:** Lightly spray thinned flat black paint to select areas. Add more where discoloration can occur (near windows, chimneys, etc.).
- **Chalk:** Rub dark pastel chalk (color suggestion: gray, black, brown, etc.) on sandpaper to create chalk dust. Using a paintbrush, dab chalk dust where discoloration can occur.

Look for these other N scale Landmark Structures Building Kits at your local hobby shop.

- PF5200 Fresh Market
- PF5203 Sonny's Super Service
- PF5204 Sicken Tire Company
- PF5206 Country Cottage
- PF5207 Woodland Station
- PF5213 Windmills
- PF5214 Davenport Department Store

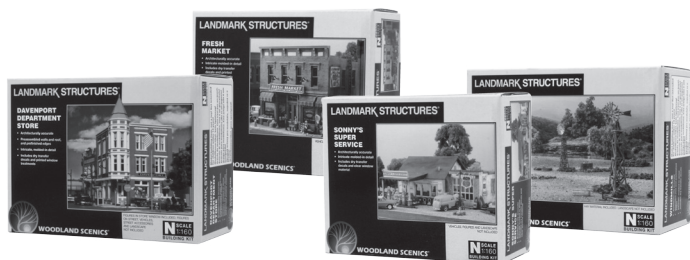

Just Plug[®] LIGHTING SYSTEM

The Just Plug Lighting System is a complete, quick and easy way to add realism to new and existing layouts and other projects. No electrical knowledge or special tools are needed. Just Plug and you're done! Individual bulb brightness can be controlled, and special window film eliminates the need for building interiors. The modular design allows for easy expansion, and Just Plug works for all scales.



**It's as easy as placing
a light and setting
your building on top.**